

- Wastewater Mains**
- 4" to 12" pipe SDR-35 with gasket.
 - 4" to 8" force main pipe SDR26 with gasket.
 - All 4" wastewater taps will use 45° WYE service.
 - All wastewater main and service must have 10 to 12 gauge tracing wire.
 - All clean-outs located in the street must have cast iron clean-out box with lid, Vulcan #V-8505.
 - Manhole lid and ring watertight, Vulcan #V-2386.
 - Manhole lid and ring standard, Vulcan #V-2342VT, with Wastewater marked on lid.
 - Manholes 5 ft. I.D., concrete only.

- Water Mains**
- All 4" to 12" pipe must be DR14 C900 class pipe.
 - All mechanical type fittings must be ductile iron type that meets all C110/A21-10 ANSI/AWWA standards.
 - All valves 2" through 12" must be CLOW resilient wedge valve. Must meet all AWWA and fire protection standards.
 - 10 to 12 gauge tracing wire (solid core) will be installed on all mains.
 - Valve boxes, adjustable cast iron two piece with lids marked water.
 - Valve box, non-adjustable 10" cast iron with lid marked water.
 - All ductile iron tees must be anchor type.
 - All ductile iron fittings must be wrapped with ductile plastic wrap.

CAUTION:
EXISTING UTILITIES AND UNDERGROUND FACILITIES OF THESE PLANS HAVE BEEN LOCATED FROM REFERENCE INFORMATION AND AS-BUILT PLANS. IT SHALL BE THE RESPONSIBILITY OF THE CONTRACTOR TO VERIFY HORIZONTAL AND VERTICAL LOCATION OF ALL EXISTING UTILITIES PRIOR TO CONSTRUCTION. THE CONTRACTOR SHALL TAKE NECESSARY PRECAUTIONS TO PROTECT ALL EXISTING UTILITIES AND WILL BE RESPONSIBLE FOR ANY DAMAGE TO SAID UTILITIES. THE CONTRACTOR SHALL NOTIFY ALL UTILITY COMPANIES PRIOR TO CONSTRUCTION.

GOD NAILS AT X+00

N	E	Z
1+00	4914.22	4974.35
2+00	4814.25	4972.86
3+00	4714.24	4871.36
4+00	4614.27	4969.86
5+00	4514.30	4968.37
6+00	4414.46	4966.27

- Fire Hydrants**
- Approved hydrants
 - Mueller Centurion
 - CLOW Medallion
 - M & H Model 129 or 929
 - Hydrants must meet or exceed all ANSI/AWWA C502 standards.
 - Must be 5 1/2" main valve with two hose nozzles and on pumper nozzle with non-kinking chains.
 - Must open left with Pentagon Operating Unit.
 - Hydrants must be field painted (red) by contractor.

STATION EQUATION
0+00 SANITARY SEWER = 6+32.25, 14.1' RT STREET PAVING



PROFILE SCALE
HORIZ.: 1" = 30'
VERT.: 1" = 5'

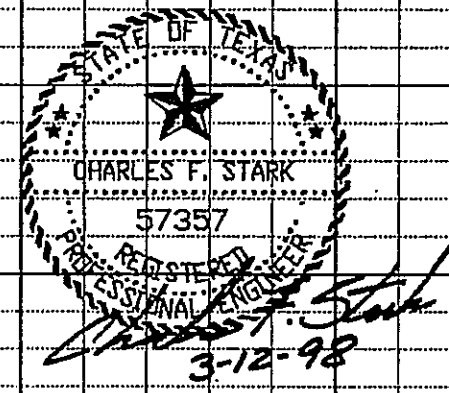
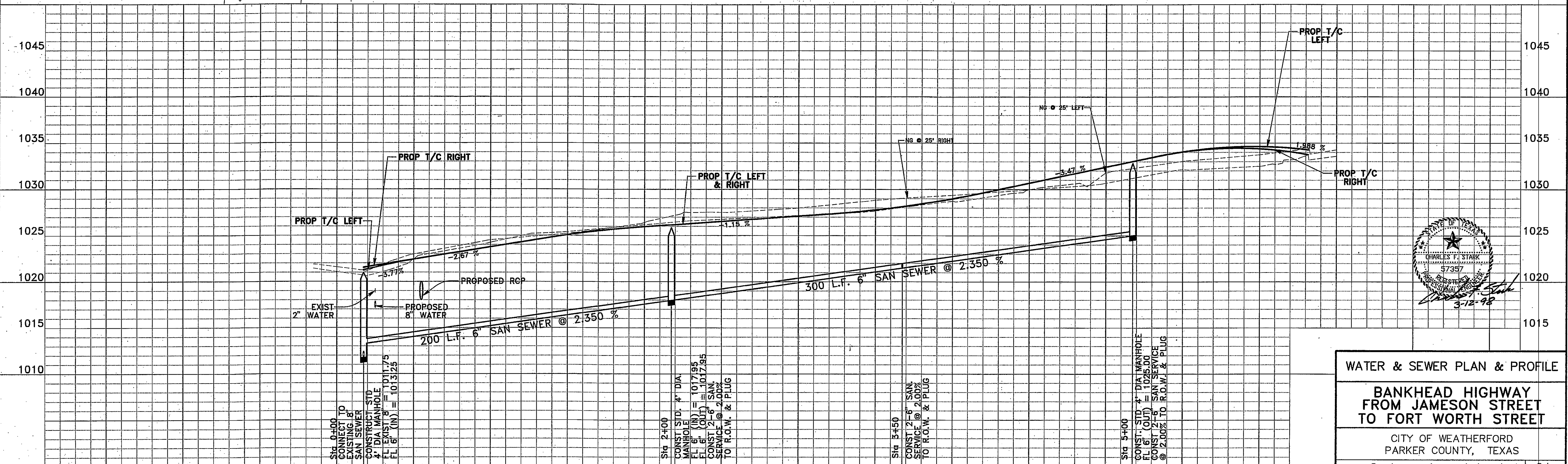

WATER & SEWER PLAN & PROFILE

BANKHEAD HIGHWAY FROM JAMESON STREET TO FORT WORTH STREET

CITY OF WEATHERFORD
PARKER COUNTY, TEXAS

Graham Associates, Inc.
CONSULTING ENGINEERS & PLANNERS
618 SIX FLAGS DRIVE, SUITE 400
ARLINGTON, TEXAS 76011 (817) 840-8535

Drawn By: J.P.K. Sheet: 4 of 6

Date: MAR. 1998
File: 980-1053