

H.J. THOMPSON SURVEY A-2432

Owner - Lot 8, Block 2: Ed D. and Eve DeMoss
 Lots 6 and 7, Block 2: Frank A. and Anna Christophe

STATE OF TEXAS COUNTY OF PARKER
 I hereby certify that this instrument was filed on the date and time stamped hereon by me and was duly recorded in the volume and page of the named records of Parker County as stamped hereon by me.
 RECORDED FEB 11 1991
 SEAL
 Carrie Reed
 County Clerk, Parker County, Tex.

202275
 RC 715
 RECEIVED AND FILED FOR RECORD
 At 11:45 O'Clock A.M.
 FEB 11 1991
 CARRIE REED, Co. Clerk
 PARKER COUNTY, TEXAS
 By Deputy

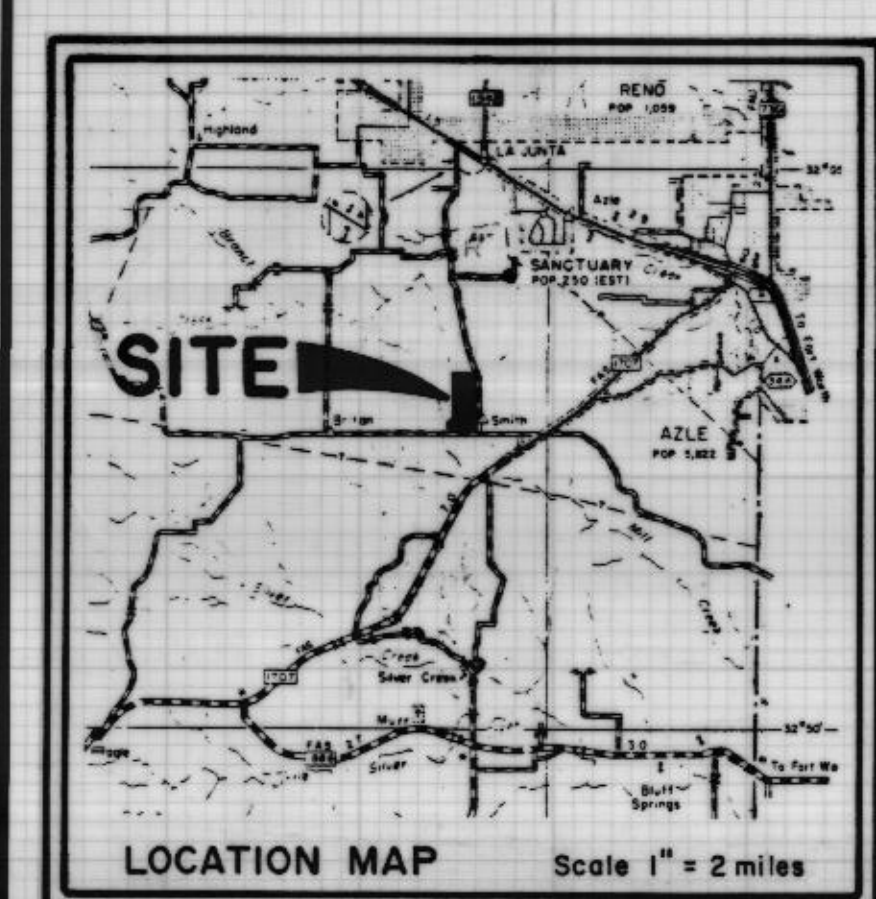

NOTE: All lot corners, angle points, points of curves, and point of tangencies were physically set. Said points were marked by one-half inch iron pins driven into the ground, unless otherwise noted on plat.

LAND USE DATA:

TOTAL LAND AREA	76.6136 ACRES
RIGHT-OF-WAY DEDICATIONS	
COUNTY ROADS	3.5515 ACRES
5 ACRE TRACTS	14
2 ACRE TRACTS	1
1 ACRE TRACTS	1

NOTES:
 1. UTILITY EASEMENTS WILL 10.0' INSIDE ALL FRONT, REAR, AND NON-ADJACENT SIDE LOT BOUNDARIES AND 8.0' ON EACH SIDE OF ADJACENT LOT SIDE BOUNDARIES, UNLESS OTHERWISE NOTED.

CORRECTED FINAL PLAT
HIGH VIEW OAKS - PHASE II
 BEING 76.6136 ACRES OF LAND OUT OF THE H.J. THOMPSON SURVEY, ABST. 2432 PARKER COUNTY, TEXAS

OWNER:
 BRIAN H. FRAZIER, TRUSTEE
 112 NW 24th ST. SUITE 407
 FORT WORTH, TEXAS 76106
 (817) 268-1442

SURVEYOR:
 E.G. GLOVER, JR.
 P.O. BOX 199
 CLEBURNE, TEXAS 76033
 (817) 645-3377

ENGINEER:
LandCon Inc.
 Engineers • Surveyors • Planners
 P.O. Box 100247
 Fort Worth, Texas 76185
 (817) 763-0127

AUGUST, 1990 SHEET 1 of 2