

MAGELLAN PIPELINE
TERMINALS, L.F.
VOL. 2563, PG. 1768
D.R.P.C.T.

JOHN H. PHELPS SURVEY
ABSTRACT NO. 1046

ELIZA OXER SURVEY
ABSTRACT NO. 1031

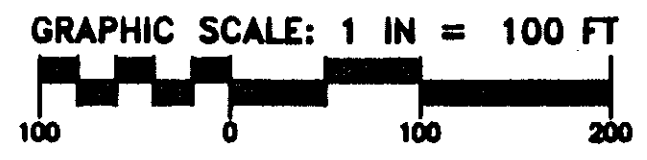
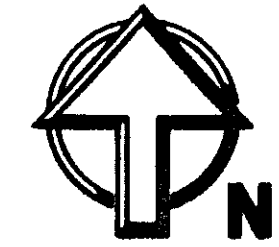

LAND USE DATA

TOTAL LAND AREA	23.189 ACRES
R-O-W DEDICATION	3,971 LF
TOTAL LOTS	88 LOTS
ESTIMATED POPULATION	308 PERSONS
MINIMUM LOT AREA	7610 SF
ZONING	R5 FAMILY RESIDENTIAL

STREET LENGTH TABLE

COLD TRACK DRIVE	535 LF
WHITETAIL DRIVE	2005 LF
CAMOUFLAGE CIRCLE	1431 LF
TOTAL LENGTH OF STREET	3971 LF

LOCATION MAP

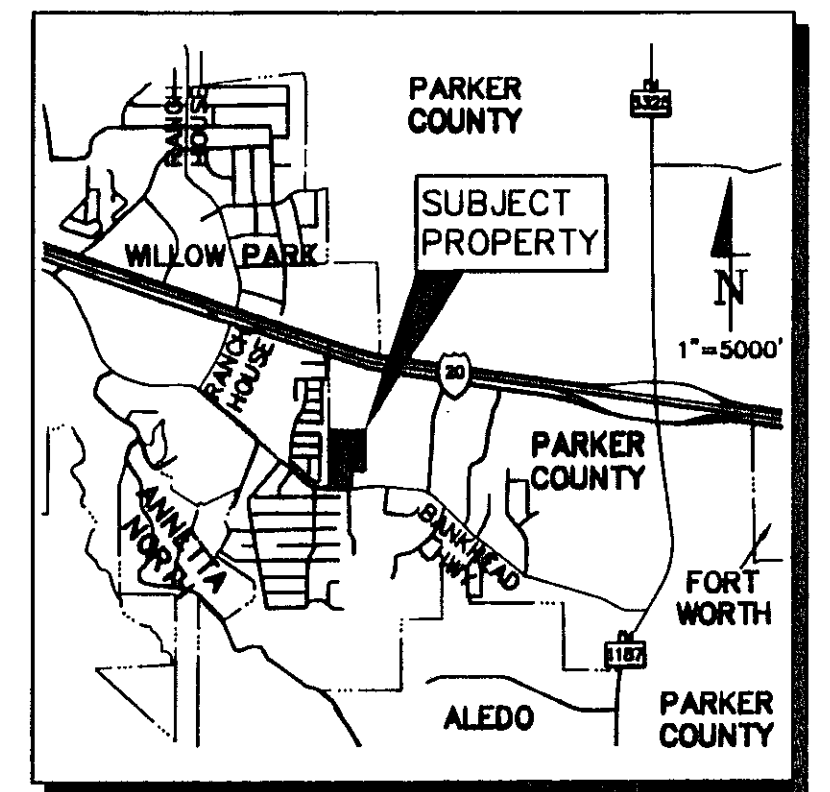

CITY OF WILLOW PARK, TEXAS

CITY APPROVAL OF FINAL PLAT

RECOMMENDED BY: Paul Feltz CHAIRPERSON DATE: 9-24-12

APPROVED BY: R. Chenderowicz MAYOR DATE: 9/20/12

ATTEST: Carroll Scott CITY ADMINISTRATOR DATE: 9/20/12

Yuel Hoffman CITY SECRETARY DATE: 9-20-2012

FINAL PLAT

LOTS 1-21, BLOCK A; LOTS 1-43, BLOCK B;
LOTS 1-10, BLOCK C; LOTS 1-14, BLOCK D

HUNTERS GLEN

BEING 23.189 ACRES OF LAND SITUATED IN THE ELIZA OXER SURVEY, ABSTRACT NUMBER 1031 AND THE JOHN H. PHELPS SURVEY, ABSTRACT NUMBER 1046 WILLOW PARK, PARKER COUNTY, TEXAS

PREPARED MAY 31, 2012
REVISED JUNE 8, 2012
REVISED JUNE 25, 2012

PREPARED BY

SD Engineering, Inc.
Site Development Engineering
PO Box 1357 Aledo, TX 76008-1357
(817) 441-8400 Fax (817) 441-8085
TEXAS REGISTERED ENGINEERING FIRM F-7843
TEXAS REGISTERED SURVEYING FIRM 10095800

PROJECT SURVEYOR
TEXAS GEOSPATIAL
TEXAS REGISTERED SURVEYING FIRM 10083300
4918 BEN DAY MURRIN RD.
FORT WORTH, TEXAS 76126
817.441.6199

OWNER/DEVELOPER:
ALEDO REALTY INVESTMENTS, LLC
PO BOX 1326
ALEDO, TEXAS 76008
817.371.6776

Cabinet D205