

Plat Cabinet "B" Slide 678

TOMMIE HUGHES AND ASSOCIATES P.C.  
Registered Professional Land Surveyors  
1414 South Main Street, Weatherford, Texas 76086  
(817)594-5374 or (817)596-0212  
3/4/2002 NO. 18121CVT

Doc 00440231 Bk DR Vol 1994 Pg 1967

FILED AND RECORDED  
OFFICIAL PUBLIC RECORDS  
On Mar 08, 2002 at 03:25P

Document Number: 00440231

Amount: .00

By Leslie Dufal

STATE OF TEXAS COUNTY OF PARKER  
I hereby certify that this instrument was  
filed on the date and time stamped herein by me  
and was duly recorded in the volume and page  
of the rated records of Parker County  
as stamped herein by me.

Mar 08, 2002

JENNIE BRANSON, COUNTY CLERK  
PARKER COUNTY

PAVED DRIVE

SECTION D

{ Plat Cabinet - A, Slide 58 }  
Plat Records, Parker County,  
Texas

SECTION B

{ Plat Cabinet - A, Slide 57 }  
Plat Records, Parker County,  
Texas

PAVED DRIVE

PAVED DRIVE

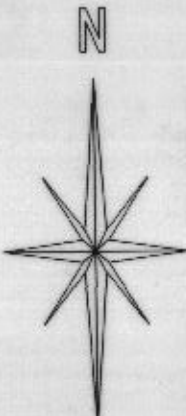

SCALE  
1"=20'

SEE PAGE ONE WHICH  
IS THE INDEX SHEET

SHEET 2

UNDEVELOPED

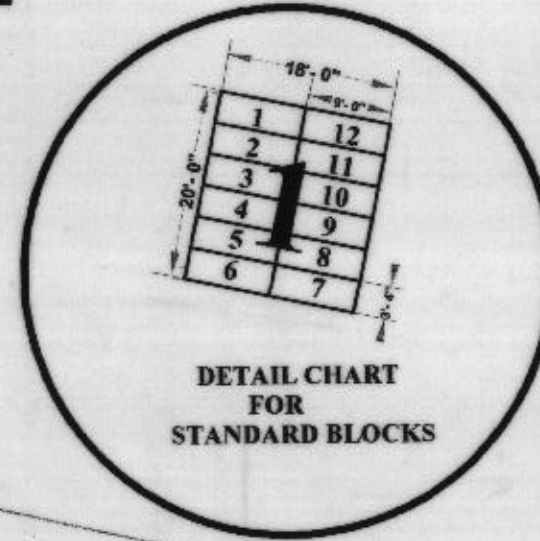

DETAIL CHART  
FOR  
STANDARD BLOCKS

GRAVEL DRIVE

MEMORY GARDENS OF THE VALLEY

SECTION - C-VET

BEING BLOCKS 1 THROUGH 84, OF  
WHICH A PORTION OF C-VET IS A  
REVISION OF ALL OF SECTION - C,  
INCLUDING BLOCKS 1 THROUGH 14,  
PARKER COUNTY MEMORIAL PARK  
AND BEING A PART OF THE R.A.  
KIDWELL SURVEY, ABSTRACT 2016,  
P.C.TEXAS ACCORDING TO THE PLAT  
RECORDED IN THE PLAT CABINET A,  
SLIDE 58, PLAT RECORDS, PARKER  
COUNTY, TEXAS.

GRAVEL DRIVE

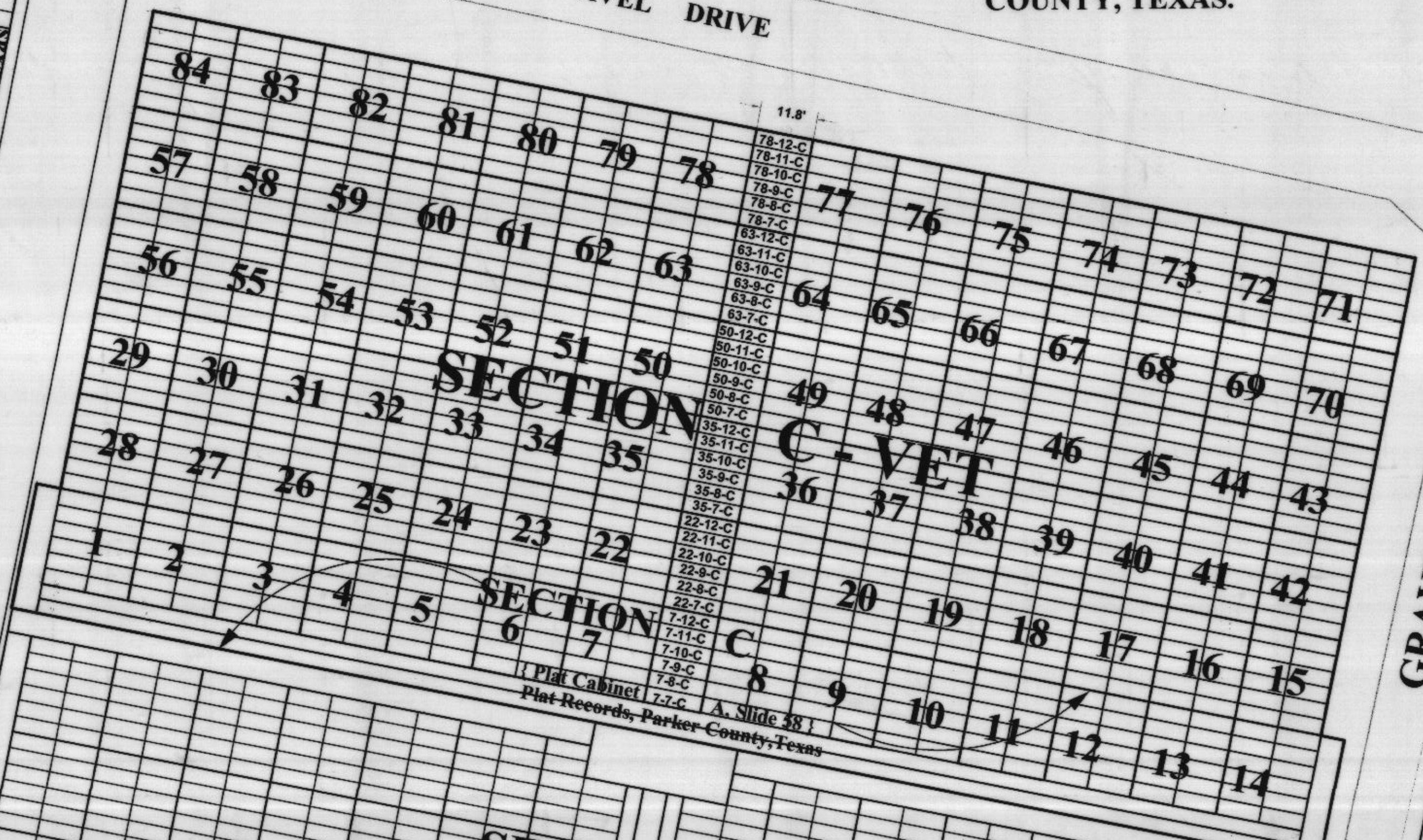

SECTION C-VET

SECTION C

SECTION A  
{ Plat Cabinet - A, Slide 57 }  
Plat Records, Parker County,  
Texas

GRAVEL DRIVE