

W. J. Spitzer 1st Feb do 1900

Housey	Torpin	Phillips	Davenport	Ray
200 69-616 1	4	173 1 57-620 192	4	190 197 1 81-63 61-433 1-549
2	3	7	3	2
293				197 193

19 1	57-565 4	1 61-247 School		190 1
2	3	7	3	7

	61-547 4			
2	3	2	3	7

1	2			
4	3			

Jno Webb		Ford	

J. E. Roberts	S. M. Roberts (Mrs. S. Roberts)
375	35-275



3  
77

*W. J. Spitzer Relictious to Knoxville  
 Park Co. Inc*

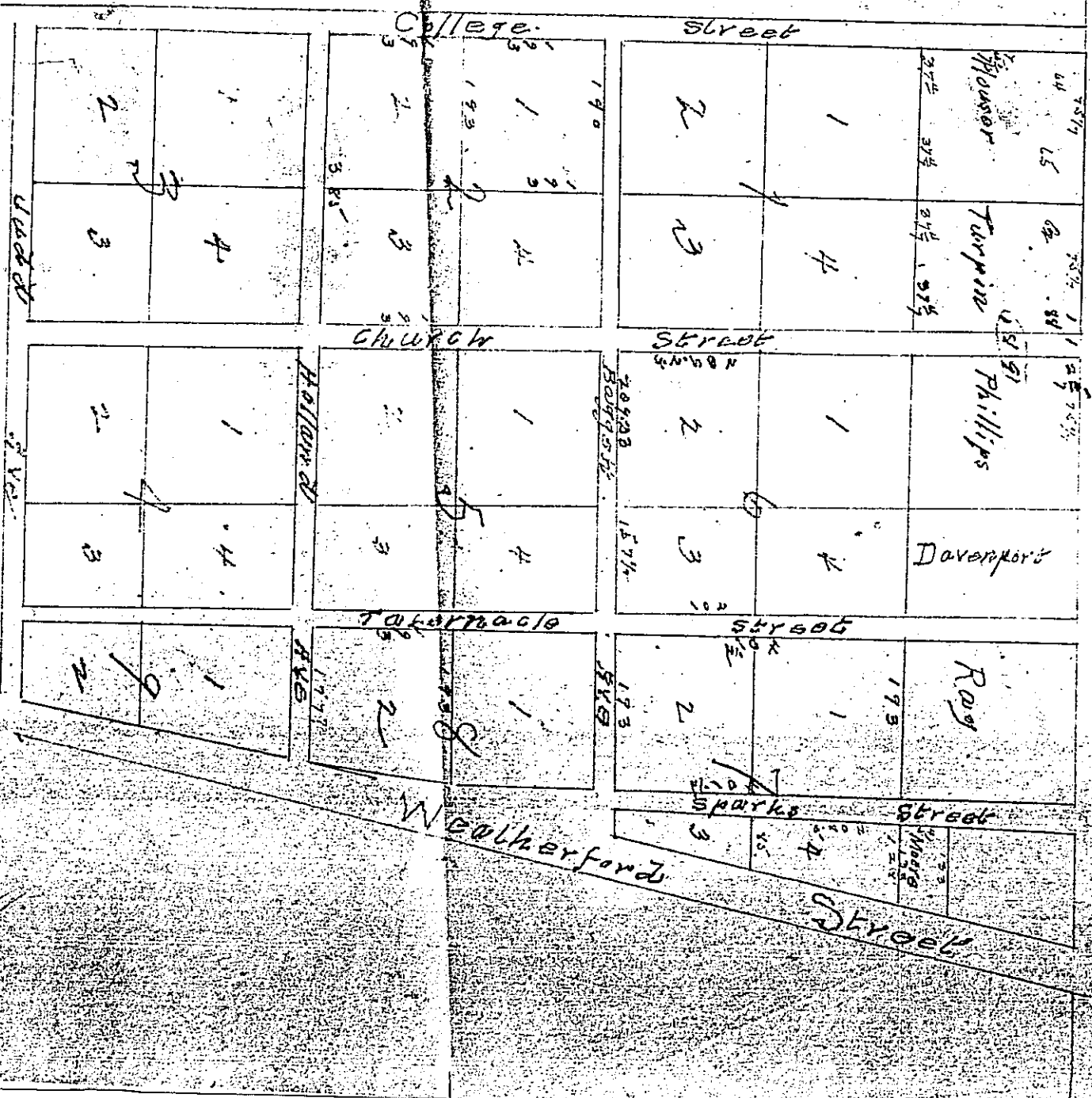

Scale of  
 1 inch =  
 100 feet

W.L. Sparks Add to Poolville

EMPSON'S ENGINEERING CO.

LIMITED

Filed Dec. 20, 1901 Book 56 Page 429

Need Records.

N

W

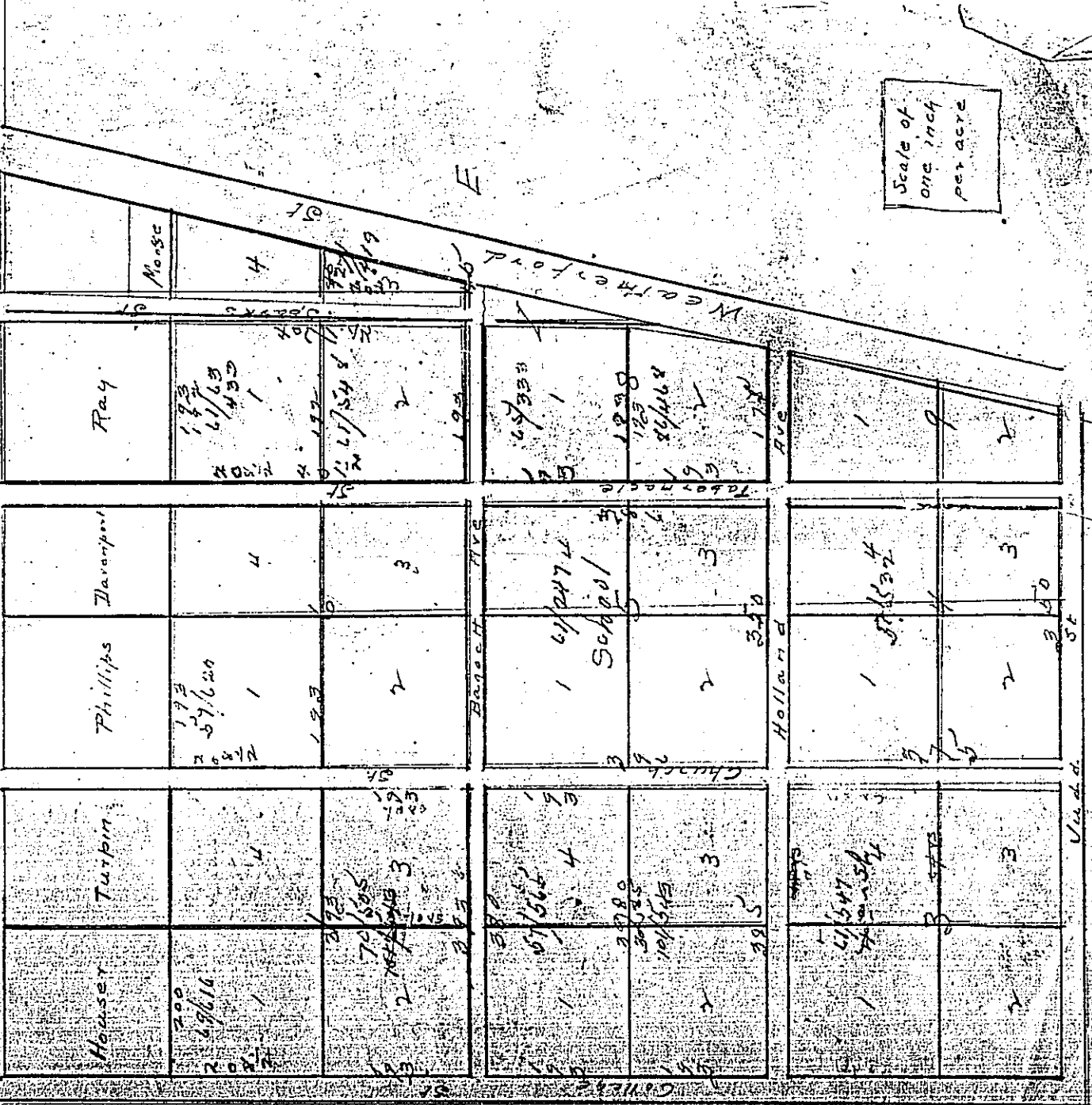

Scale of one inch per acre