

VICINITY MAP (NTS)

STATE OF TEXAS
COUNTY OF PARKER

Approved by the Commissioners Court of Parker County, Texas, this the
27th day of February, 2002.

[Signature]
County Judge
[Signature]
Commissioner Precinct No. 1
[Signature]
Commissioner Precinct No. 3

[Signature]
Commissioner Precinct No. 2
[Signature]
Commissioner Precinct No. 4

NOTE: PARKER COUNTY COMMISSIONER'S COURT APPROVAL ONLY FOR THAT PORTION OF SECTOR ONE LOCATED IN UNINCORPORATED AREAS.

Doc 00439318 Bk OR Vol 1992 Pg 885

FILED AND RECORDED
OFFICIAL PUBLIC RECORDS
On: Feb 27, 2002 at 12:47P

Document Number: 00439318
Amount: .00
By: Belinda Eystone

B-670

STATE OF TEXAS COUNTY OF PARKER
I hereby certify that this instrument was filed on the date and time stamped herein by me and was duly recorded in the volume and page of the named records of Parker County as stamped herein by me.
Feb 27, 2002

JEANIE BRUNSON, COUNTY CLERK
PARKER COUNTY

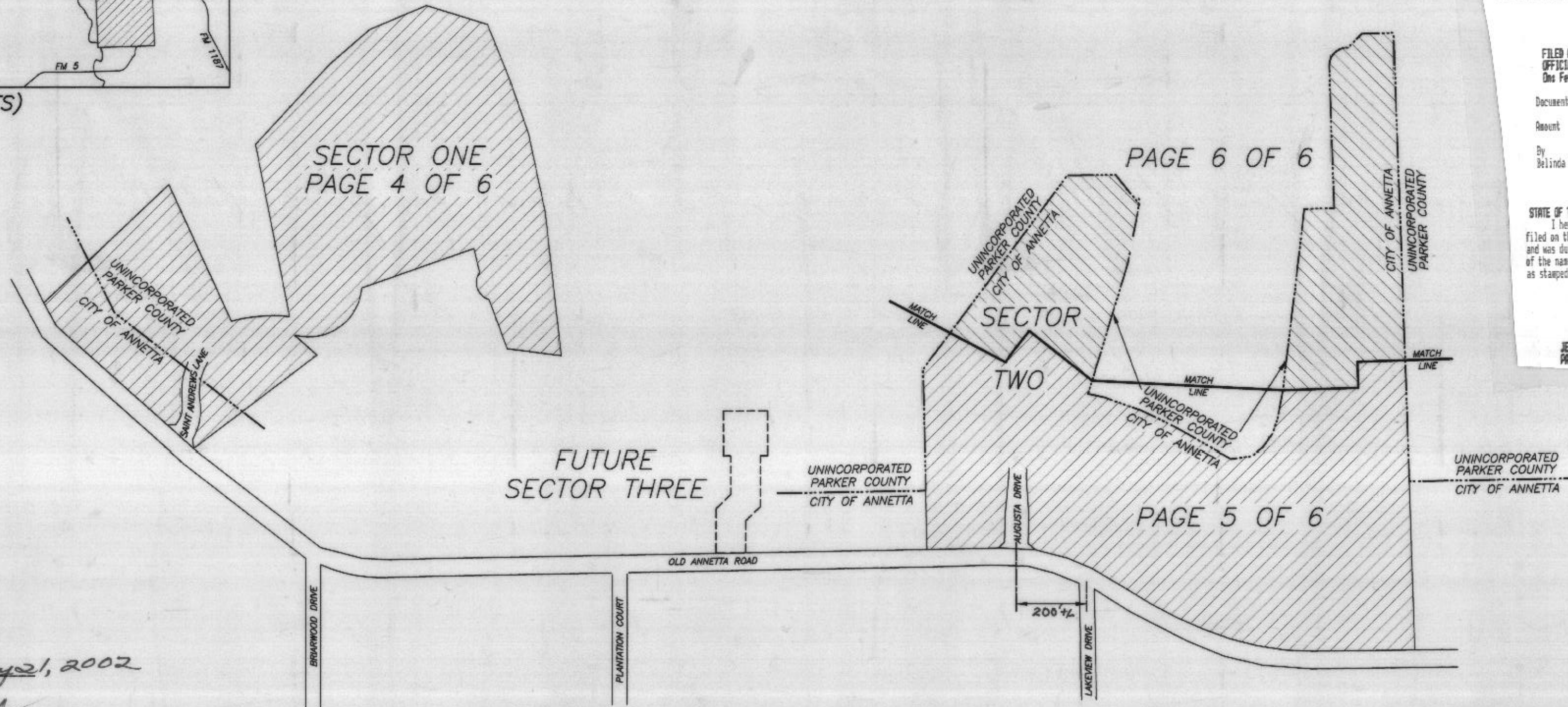

CITY OF ANNETTA
PARKER COUNTY, TEXAS

Plat Approved Date: February 21, 2002

[Signature]
Mayor
[Signature]
Secretary

Final Plat
Lots 1-8 and Tract A, Block 1;
Lots 1-15, Block 3;
SECTOR ONE
Lots 1-31, Block 4; and Lots 1-28, Block 5
SECTOR TWO
SPLIT RAIL
ESTATES

Being 67.720 Acres, in Two Tracts, Situated In The
F.L. BLODGET SURVEY - ABST. NO. 87;
I. & G.N. RR. CO. SURVEY NO. 3 - ABST. NO. 1814;
WILLIAM NATIONS SURVEY - ABST. NO. 1002; And The
JOSEPH CARROLL SURVEY - ABST. NO. 293,
City of Annetta, Parker County, Texas, And
Unincorporated Parker County, Texas
Current Zoning: G-1 Golf Course Estates

THIS is to certify that I, Brent A. Mizell, a Registered Professional Land Surveyor of the State of Texas, have plotted the above subdivision from an actual survey on the ground; and, upon completion of street and utility construction, all lot corners, angle points, and points of curve shall be properly marked on the ground, and that this plat correctly represents that survey made by me or under my direction and supervision.

[Signature]
BRENT A. MIZELL
REGISTERED PROFESSIONAL LAND SURVEYOR
TEXAS REGISTRATION NO. 1967
JANUARY 30, 2002



OWNER - DEVELOPER
PHILIP G. LUMSDEN AND
NELLIE J. LUMSDEN
103 WILD BRIAR COURT
ALEDO, TEXAS 76008
817-441-1635

B-670

MIZELL LAND SURVEYING, INC.
513 North Highway 1187, Suite 5
P.O. Box 1029 Aledo, TX 76008
817-441-6199 FAX: 817-441-6805