

REPLAT OF LOTS 2-R, 3-R AND 4-R, BLOCK 10, BRIARWOOD SUBDIVISION, PATIO HOMES SECTION, CITY OF WEATHERFORD, PARKER COUNTY, TEXAS

Plat Cabinet B-200

309475

RECEIVED AND FILED  
 PUBLIC RECORD  
 10:45 O'clock A.M.

MAR 12 1997

Jeanne Brunson, Co. Clerk  
 PARKER COUNTY, TEXAS  
 By D. Brooks Deputy

STATE OF TEXAS COUNTY OF PARKER  
 I hereby certify that this instrument was filed with the Public Record Office on the date and time stamped herein by me and was duly recorded in the volume and page of the public records of Parker County as stamped hereon.  
 MAR 12 1997

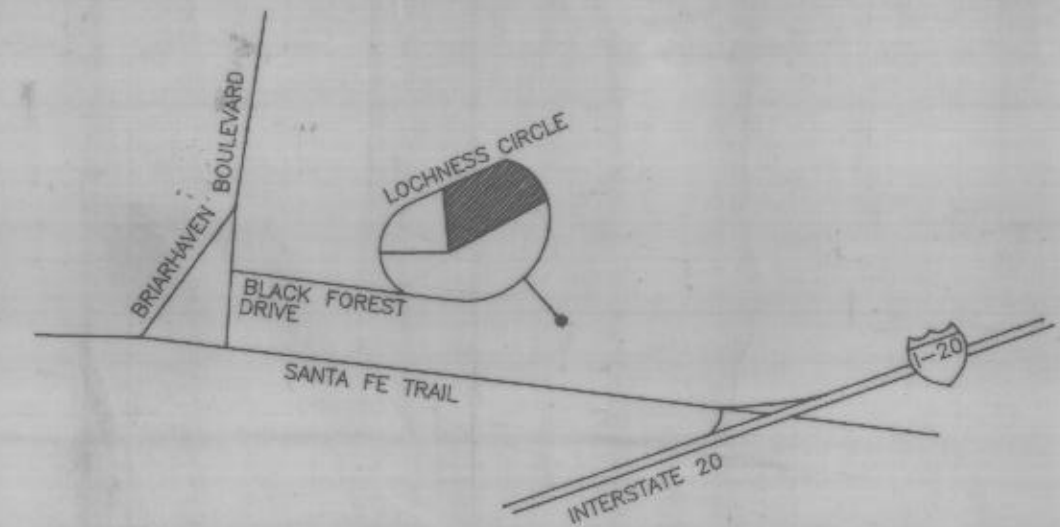

SITE MAP

THIS is to certify that I, David Harlan Jr., a Registered Public Land Surveyor of the State of Texas, have platted the above subdivision from an actual survey on the ground and all lot corners, angle points and points of curve are properly marked on the ground, and that this plat correctly represents that survey made by me or under my supervision.

David Harlan Jr.  
 David Harlan, Jr.  
 R.P.L.S. No. 2074



CITY APPROVAL STATEMENT

APPROVED BY THE CITY OF WEATHERFORD, TEXAS, PURSUANT TO THE AUTHORITY DELEGATED TO THE CITY SECRETARY UNDER SECTION 2.5, ARTICLE 2 ORDINANCE 1991-1 AND SECTION 212.0065, TEXAS LOCAL GOVERNMENT CODE ALLOWING FOR ADMINISTRATIVE APPROVAL OF CERTAIN PLAT VACATIONS, CORRECTIONS, REPLATS OR MINOR PLATS AS DESCRIBED THEREIN.

2-26-97 Bettye Farris  
 DATE CITY SECRETARY CITY OF WEATHERFORD, TEXAS



5.00  
 1.00  
 53.00  
 59.00

STATEMENT ACKNOWLEDGING VISIBILITY TRIANGLES

"There shall be provided at the intersections of all public streets, visibility triangles as required by Section 8.7 of the Subdivision Ordinance of the City."

NOTE: We do hereby waive all claims for damages against the City occasioned by the establishment of grades or the alterations of the surface of any portion of the existing streets and alleys, or natural contours, to conform to the grades established in the subdivision.

ALL BUILDING SET BACK LINES SHALL CONFORM TO CURRENT ZONING ORDINANCES OF THE CITY OF WEATHERFORD, PARKER COUNTY, TEXAS

DEED RESTRICTION CERTIFICATION STATEMENT

I hereby certify that the area of this plat does not include any lots of a prior subdivision limited by deed restriction to residential use for not more than two residential units per lot.

Richard  
 Owner  
 SWORN TO AND SUBSCRIBED before me this 26<sup>th</sup> day of February 1997  
Vicki S. Garvin  
 Notary Public in and for the State of Texas

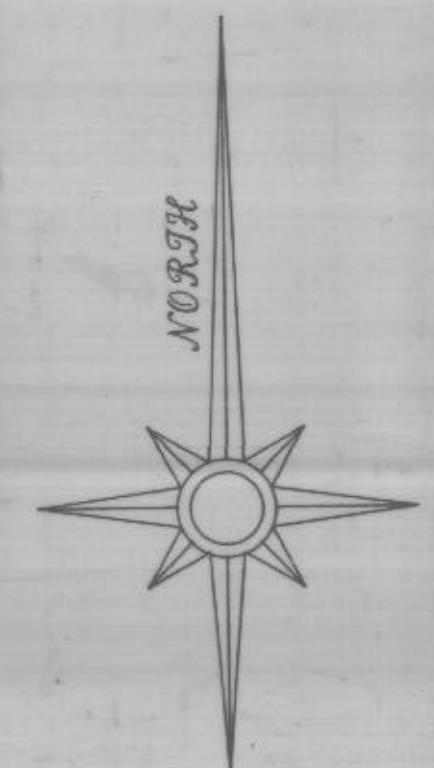
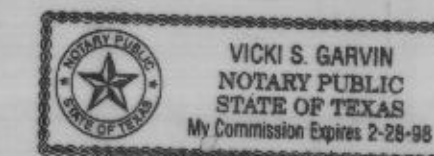

SCALE: 1" = 20'

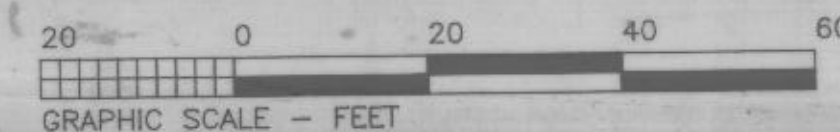

HARLAN LAND SURVEYING  
 215 EAST EUREKA  
 WEATHERFORD, TX 76086  
 METRO (817) 596-9700 (817) 599-0880

