

COLLINS PARK PLACE ADDITION
 AN ADDITION TO THE CITY OF WEATHERFORD, PARKER COUNTY, TEXAS, BEING A SUBDIVISION OF A 14.695 ACRE TRACT SITUATED IN THE H. INMAN SURVEY, ABSTRACT No. 724, PARKER COUNTY, TEXAS

HARLAN LAND SURVEYING
 215 E. EUREKA
 WEATHERFORD, TEXAS
 (817) 599-0880, METRO (817) 596-9700

DEVELOPER: JACKIE W. COLLINS AND VIRGINIA SMITH COLLINS
 4501 FM 920
 WEATHERFORD, TX 76086
 (817) 596-0127

THIS is to certify that I, David Harlan, Jr., a Registered Public Land Surveyor of the State of Texas, have platted the above subdivision from an actual survey on the ground; and all lot corners, angle points and points of curve are properly marked on the ground, and that this plat correctly represents that survey made by me or under my supervision.

David Harlan, Jr.
 David Harlan, Jr.
 R.P.L.S. No. 2074

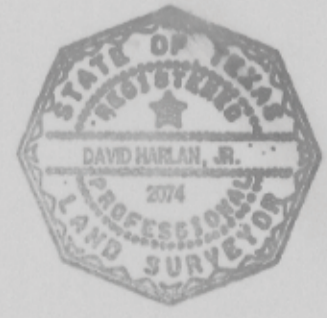

STATEMENT ACKNOWLEDGING VISIBILITY TRIANGLES

"There shall be provided at the intersections of all public streets, visibility triangles as required by Section 8.7 of the Subdivision Ordinance of the City."

NOTE: We do hereby waive all claims for damages against the City occasioned by the establishment of grades or the alterations of the surface of any portion of the existing streets and alleys, or natural contours, to conform to the grades established in the subdivision.

ALL BUILDING SET BACK LINES SHALL CONFORM TO CURRENT ZONING ORDINANCES OF THE CITY OF WEATHERFORD, PARKER COUNTY, TEXAS

814A

6-100