

THIS TRACT Does Not APPEAR TO BE IN THE SPECIAL FLOOD HAZARD AREA ACCORDING TO THE DEPT OF HOUSING AND URBAN DEVELOPMENT, FIA FLOOD HAZARD BOUNDARY MAP.

NO. 480520 0200 B  
DATE: Sept. 27, 1991

NOTE: The bearings are correlated with Interstate Hwy 20 datum.

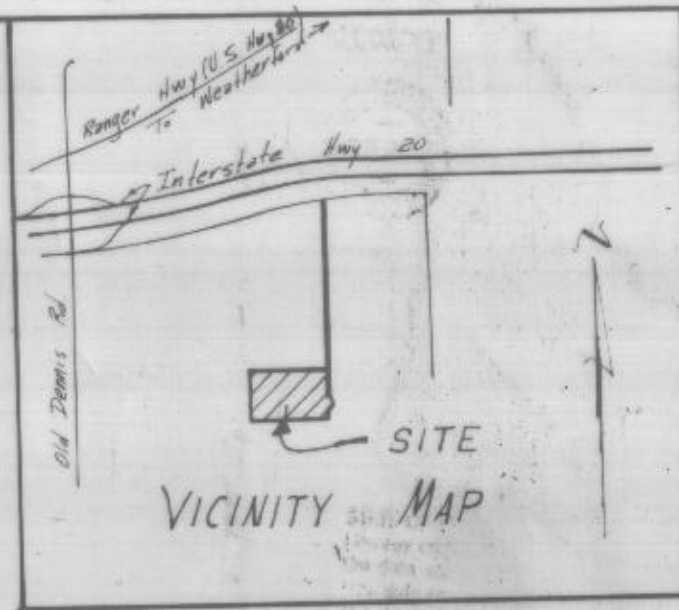

INTERSTATE HWY. N° 20  
(ACCESS ROAD)

CURVE R. 5554.38', L. 60.35'  
N85°51'44" E, 60.35'

1743.38' AC. PRIVATE ROAD  
2132.13'

HANNIBAL GOOD SUR. AB. - 536

A part of that tract of land from Paul to Ingram  
Vol. - 319, Pg. - 453  
D. R. P. C. T.

Ingram to Carter  
Book - 1460, Pg. - 1222  
D. R. P. C. T.

Bullard to Hamilton  
Book - 1535, Pg. - 739  
D. R. P. C. T.

Harris to Caudill  
Book - 1410, Pg. - 599  
D. R. P. C. T.

Gallman to Gallman  
Book - 1396, Pg. - 1005  
D. R. P. C. T.

LOT - 1  
5.0 AC.

BLOCK - 1  
LOT - 2  
5.0 AC.

CURVE R. - 60.0', L. - 157.08'  
S15°00' W, 115.91'

SOUTH, 81.46'

SOUTH, 2395.03' @ N88°50'43" W, 1092.26'  
FROM THE N E COR. OF THE HANNIBAL GOOD SUR. AB. - 536.

SCALE: 1" = 300'

Graphic Scale



This plat or field note description is not intended to express or imply a warranty or guarantee of ownership or that there are no encumbrances on the tract described. The certification hereon is only to the person who commissioned the survey, and is not intended to imply that any adjoining tracts referenced on this document have been actually surveyed on the ground. The surveyor will only be responsible for errors in an amount no greater than the fee he charged.

COY CARTER'S SUBDIVISION  
BEING A PART OF THE HANNIBAL GOOD SUR.  
AB. - 536.  
PARKER COUNTY, TEXAS

FIELD NOTES

FIELD NOTES of a 13.18 acre tract of land being a part of the HANNIBAL GOOD SURVEY, Abstract 536, Parker County, Texas and being more fully described by metes and bounds as follows:

- BEGINNING at a found 1/2" steel rod, said point being South, 2395.03 ft. and N 88 deg. 50 min. 43 sec. W, 1092.26 ft. from the NE corner of the Hannibal Good Survey, Abstract 536;
- THENCE N 88 deg. 50 min. 43 sec. W, 792.87 ft. to a found 1/2" steel rod for a corner;
- THENCE N 01 deg. 05 min. 11 sec. E, 575.0 ft. to a found 1/2" steel rod for a corner;
- THENCE S 88 deg. 50 min. 43 sec. E, 751.96 ft. to a found 1/2" steel rod for a corner;
- THENCE North, 1743.38 ft. to a found 1/2" steel rod in the SBL of Interstate Highway 20, for a corner;
- THENCE with the SBL of the above mentioned highway and with a Curve to the Right, said curve having the following datum: Radius 5554.38 ft., Chord N 83 deg. 51 min. 44 sec. E, 60.35 ft., a distance of 60.35 ft. to a found 1/2" steel rod for a corner;
- THENCE South, 2132.13 ft. to a found 1/2" steel rod for a corner; said point being the PC of a Curve to the Right;
- THENCE with the above mentioned Curve to the Right, said curve having the following datum: Radius 60.0 ft., Chord S 15 deg. 00 min. W, 115.91 ft., a distance of 157.08 ft. to a found 1/2" steel rod for a corner;
- THENCE South, 81.46 ft. to the point of beginning and containing 13.18 acres of land, more or less.

**TOMMIE HUGHES AND ASSOCIATES**  
Registered Professional Land Surveyors  
1414 S. MAIN STREET WEATHERFORD, TEXAS  
Office 594-5374 or 596-0212 Home 594-2165

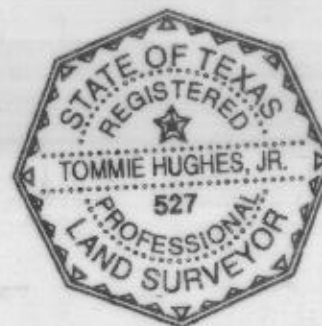

I, Tommie Hughes, Jr. certify that this map was prepared from field notes of an actual ground survey made by me or under my supervision and to the best of my knowledge and belief represents said survey, and that there are no visible encroachments or protrusions other than those shown on the plat.

Date Nov. 18, 1993 No. 15,953

DEDICATION

THE STATE OF TEXAS :  
COUNTY OF PARKER :

WHEREAS, We, Coy Carter and wife Bobbie Jean Carter, and D. L. Ingram, the owners of the above described 13.18 acre tract of land being a part of the Hannibal Good Survey, Abstract 536, Parker County, Texas DO HEREBY ADOPT THE FOREGOING PLAT TO BE KNOWN AS COY CARTER'S SUBDIVISION, a subdivision in Parker County, Texas, WITH THE ROAD SHOWN HEREON AS A PRIVATE ROAD.

Coy Carter  
Bobbie Jean Carter  
D. L. Ingram

THE STATE OF TEXAS :  
COUNTY OF PARKER :

BEFORE ME, the undersigned authority, a Notary Public in and for said County and State, on this day personally appeared Coy Carter + Bobbie Jean Carter known to me to be the person(s) whose name(s) is/are subscribed to the above and foregoing instrument, and acknowledged to me that he/she (they) executed the same for the purposes and considerations therein expressed, in the capacity therein stated.

GIVEN UNDER MY HAND AND SEAL OF OFFICE THIS THE 24 day of March, 1994



John D. Kipppatrick  
Notary Public, State of Texas  
Print Name: \_\_\_\_\_  
Commission Expires: \_\_\_\_\_

252396  
Plat Abstract 2  
005

RECEIVED AND FILED  
FOR RECORD  
2:00 O'Clock P.M.

MAR 30 1994

Jeanne Brunson, Co. Clerk  
PARKER COUNTY, TEXAS

STATE OF TEXAS COUNTY OF PARKER  
I hereby certify that the instrument described on the date and time stamped herein by me and was duly recorded in the volume and page of the Public Records of Parker County as shown herein by me.

RECORDED MAR 30 1994



THE STATE OF TEXAS :  
COUNTY OF PARKER :

BEFORE ME, the undersigned authority, a Notary Public in and for said County and State, on this day personally appeared D. L. Ingram known to me to be the person(s) whose name(s) is/are subscribed to the above and foregoing instrument, and acknowledged to me that he/she (they) executed the same for the purposes and considerations therein expressed, in the capacity therein stated.

GIVEN UNDER MY HAND AND SEAL OF OFFICE THIS THE 24 day of March, 1994.



Dorothy E. Smith  
Notary Public, State of Texas  
Print Name: Dorothy E. Smith  
Commission Expires: 10-1-94

THE STATE OF TEXAS :  
COUNTY OF PARKER :

The undersigned, as lien holder(s) on the acreage subdivided according to this plat, hereby consent to such subdivision and join in the dedication of the streets and easements.

Bobby Joe Tipton

THE STATE OF TEXAS :  
COUNTY OF PARKER :

BEFORE ME, the undersigned authority, a Notary Public in and for said County and State, on this day personally appeared Bobby Joe Tipton known to me to be the person(s) whose name(s) is/are subscribed to the above and foregoing instrument, and acknowledged to me that he/she (they) executed the same for the purposes and considerations therein expressed, in the capacity therein stated.

GIVEN UNDER MY HAND AND SEAL OF OFFICE THIS THE 24 day of March, 1994



John D. Kipppatrick  
Notary Public, State of Texas  
Print Name: \_\_\_\_\_  
Commission Expires: \_\_\_\_\_

THE STATE OF TEXAS :  
COUNTY OF PARKER :

The undersigned, as lien holder(s) on the acreage subdivided according to this plat, hereby consent to such subdivision and join in the dedication of the streets and easements.

THE STATE OF TEXAS :  
COUNTY OF PARKER :

BEFORE ME, the undersigned authority, a Notary Public in and for said County and State, on this day personally appeared \_\_\_\_\_ known to me to be the person(s) whose name(s) is/are subscribed to the above and foregoing instrument, and acknowledged to me that he/she (they) executed the same for the purposes and considerations therein expressed, in the capacity therein stated.

GIVEN UNDER MY HAND AND SEAL OF OFFICE THIS THE \_\_\_\_\_ day of \_\_\_\_\_, 1993.

Notary Public, State of Texas  
Print Name: \_\_\_\_\_  
Commission Expires: \_\_\_\_\_

APPROVED BY THE PARKER COUNTY COMMISSIONERS, this the 28th day of March, 1993.

ACCEPTED BY: Ben Long County Judge  
Waymon Wright  
Mark Dobb  
Mark Dobb

No. 15,953