

**LOCATION MAP**  
(No Scale)

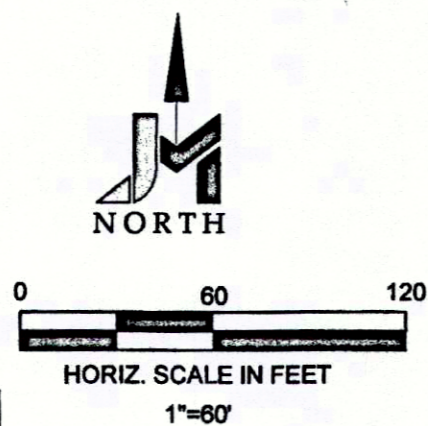
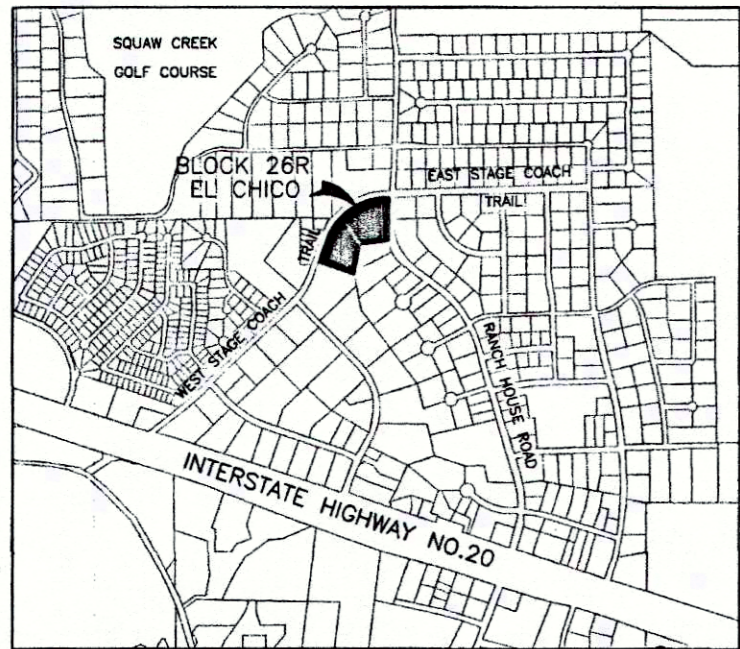

TO:  
L. C. CHERRY et al  
AS TRUSTEES AND THEIR  
SUCCESSORS IN OFFICE FOR  
FIRST BAPTIST CHURCH OF  
WILLOW PARK, TX  
1420 - 1264

**COACH TRAIL**

TO:  
DAVID C. and  
CHRISTINE S.  
LAURENZO  
1534 - 1600

(L=36.07')  
R=563.94'

TO:  
WILLOW PARK STAGE  
COACH PROPERTIES  
1534 - 1600  
(TRACT TWO)

TO:  
WILLOW PARK STAGE  
COACH PROPERTIES  
1534 - 1600  
(TRACT SIX)

TO:  
WILLOW PARK STAGE  
COACH PROPERTIES  
1534 - 1600  
(TRACT ONE)

TO:  
WILLOW PARK STAGE  
COACH PROPERTIES  
1534 - 1600  
(TRACT FOUR)

TO:  
WILLOW PARK STAGE  
COACH PROPERTIES  
1534 - 1600  
(TRACT THREE)

TO:  
WILLOW PARK STAGE  
COACH PROPERTIES  
1534 - 1600  
(TRACT FIVE)

N 69°54'49.45"  
E 223°31'76.90"

'CARTER 5691'  
CAPPED 1/2" LR. FND.  
BEARS N16°47'E, 0.62'

TO:  
WILLOW PARK STAGE  
COACH PROPERTIES  
1534 - 1600  
(TRACT TWO)

TO:  
WILLOW PARK STAGE  
COACH PROPERTIES  
1534 - 1600  
(TRACT SIX)

TO:  
WILLOW PARK STAGE  
COACH PROPERTIES  
1534 - 1600  
(TRACT ONE)

TO:  
WILLOW PARK STAGE  
COACH PROPERTIES  
1534 - 1600  
(TRACT FOUR)

TO:  
WILLOW PARK STAGE  
COACH PROPERTIES  
1534 - 1600  
(TRACT THREE)

TO:  
WILLOW PARK STAGE  
COACH PROPERTIES  
1534 - 1600  
(TRACT FIVE)

TO:  
WILLOW PARK STAGE  
COACH PROPERTIES  
1534 - 1600  
(TRACT TWO)

TO:  
WILLOW PARK STAGE  
COACH PROPERTIES  
1534 - 1600  
(TRACT SIX)

TO:  
WILLOW PARK STAGE  
COACH PROPERTIES  
1534 - 1600  
(TRACT ONE)

TO:  
WILLOW PARK STAGE  
COACH PROPERTIES  
1534 - 1600  
(TRACT FOUR)

TO:  
WILLOW PARK STAGE  
COACH PROPERTIES  
1534 - 1600  
(TRACT THREE)

TO:  
WILLOW PARK STAGE  
COACH PROPERTIES  
1534 - 1600  
(TRACT FIVE)

TO:  
WILLOW PARK STAGE  
COACH PROPERTIES  
1534 - 1600  
(TRACT TWO)

TO:  
WILLOW PARK STAGE  
COACH PROPERTIES  
1534 - 1600  
(TRACT SIX)

TO:  
WILLOW PARK STAGE  
COACH PROPERTIES  
1534 - 1600  
(TRACT ONE)

TO:  
WILLOW PARK STAGE  
COACH PROPERTIES  
1534 - 1600  
(TRACT FOUR)

TO:  
WILLOW PARK STAGE  
COACH PROPERTIES  
1534 - 1600  
(TRACT THREE)

TO:  
WILLOW PARK STAGE  
COACH PROPERTIES  
1534 - 1600  
(TRACT FIVE)

TO:  
WILLOW PARK STAGE  
COACH PROPERTIES  
1534 - 1600  
(TRACT TWO)

TO:  
WILLOW PARK STAGE  
COACH PROPERTIES  
1534 - 1600  
(TRACT SIX)

TO:  
WILLOW PARK STAGE  
COACH PROPERTIES  
1534 - 1600  
(TRACT ONE)

TO:  
WILLOW PARK STAGE  
COACH PROPERTIES  
1534 - 1600  
(TRACT FOUR)

TO:  
WILLOW PARK STAGE  
COACH PROPERTIES  
1534 - 1600  
(TRACT THREE)

TO:  
WILLOW PARK STAGE  
COACH PROPERTIES  
1534 - 1600  
(TRACT FIVE)

**EAST STAGE  
COACH TRAIL**

**RANCH HOUSE ROAD**

**EL CHICO  
BLOCK**

**NOTES**

- NOTICE:** Selling a portion of this addition by metes and bounds is a violation of city ordinance and state law, and is subject to fines and withholding of utilities and building permits.
- OWNER AND DEVELOPER AT TIME OF PLATTING:** City of Willow Park, 516 Ranch House Road, Willow Park, Texas, 817-441-7108
- FLOOD ZONE:** By scaled map location of FEMA's Flood Insurance Rate Map No. 48387C0425E, with an Effective Date of September 26, 2008, a portion of Blocks 26 and 27 El Chico depicted hereon lies within Special Flood Hazard Area Zone AE (Base Flood Elevation established).
- CURRENT ZONING:** At the time of platting the City of Willow Park on line resources depict Block 26 and 27, El Chico to be Zoned R1 - Single Family.
- This replat does not vacate the previous plat of record governing the remainder of the subdivision, nor does it amend or remove any deed covenants or restrictions.
- LOT AREA:** 7.6066 Acres (331,346 square feet).
- Bearings and distances shown hereon are relative to the Texas Coordinate System of 1983, North Central Zone, as derived by GPS observations. Distances shown hereon are grid distances and can be converted to surface distances by multiplying each distance by a project combined scale factor of 1.00015. Area reported is surface area.
- Texas law requires calling toll-free 811 or 1-800-545-6005 at least 48 hours before excavating. 16 TAC Chapter 18, defines excavation as the movement of the earth by any means.

**FINAL PLAT**

**Plat of**  
**BLOCK 26R, EL CHICO,**  
being a replat of Block 26 and Block 27,  
El Chico, in the City of Willow Park, Parker  
County, Texas, as shown on plat thereof  
recorded in Cabinet A, Slide 191, Parker County  
Plat Records.

Compiled from deeds, records and surveys made on the ground.  
The corners are marked or referenced as shown.

JACOB & MARTIN, LLC.  
Consulting Engineers  
TBPLS FIRM REGISTRATION NO. 10193992



20147.010.001.00  
17060.016.001.00

August 18, 2017

Robert "Bob" Viscome, RPLS  
Texas Registration No. 5605

THIS PLAT FILED IN

Cabinet **E**, Slide **14**

**JACOB & MARTIN**  
3485 CURRY LANE  
ABILENE, TX 79608  
325-895-1070  
1508 SANTA FE DR, STE 203  
WEATHERFORD, TX 76089  
817-594-8880  
TBPLS FIRM # 10193992 FIRM # F-2448