

H750B

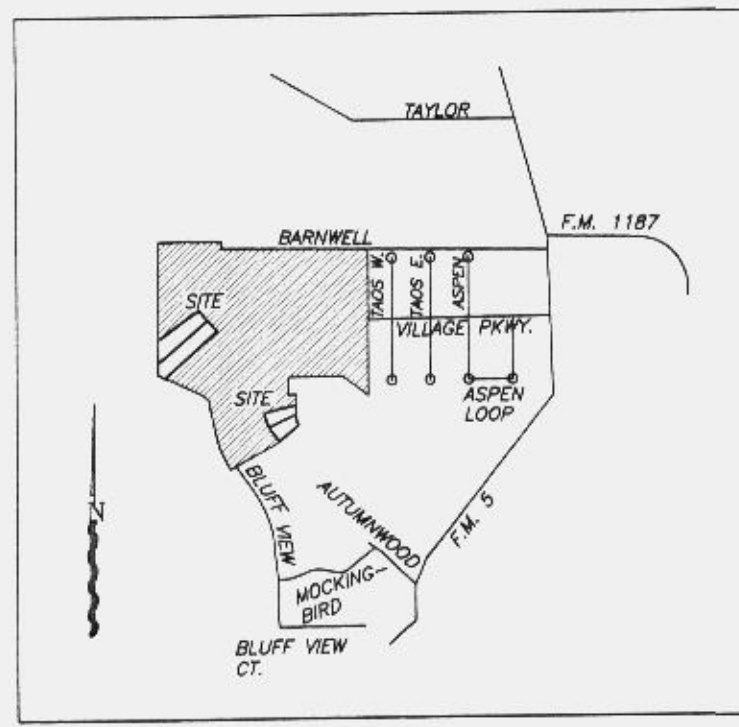

VICINITY MAP
NTS

JOHN B. HUBBERT SURVEY
ABST. NO. 613

TANGENT TABLE

COURSE	BEARING	DISTANCE
(T-1)	S 51°28'38"E	44.31'
(T-2)	N 00°07'00"E	71.44'
(T-3)	S 41°32'00"E	22.36'
(T-4)	N 1°24'48"W	43.61'
(T-5)	N 1°45'27"W	41.65'
(T-6)	N 05°26'46"W	36.03'
(T-7)	N 53°36'16"W	63.65'
(T-8)	N 65°27'01"W	56.11'
(T-9)	N 65°36'25"W	67.27'
(T-10)	N 64°14'07"W	51.25'
(T-11)	N 65°27'01"W	68.91'
(T-12)	N 67°14'14"W	59.07'
(T-13)	N 55°34'53"W	28.66'
(T-14)	N 89°33'00"E	22.80'
(T-15)	N 89°33'00"E	11.93'
(T-16)	S 14°54'37"E	35.67'

I HEREBY CERTIFY THAT THIS PLAT WAS PREPARED FROM A SURVEY ON THE GROUND UNDER MY SUPERVISION.

Brent A. Mizell
BRENT A. MIZELL
REGISTERED PROFESSIONAL LAND SURVEYOR
TEXAS REGISTRATION NO. 1967
MAY 27, 2003
REVISED JUNE 24, 2003



CURVE TABLE

CURVE	RADIUS	TANGENT	LENGTH	DELTA	DEGREE	CHORD	CH. BEARING
(C-1)	375.00'	9.40'	18.79'	02°52'17"	15°16'44"	18.79'	S 89°22'49"E
(C-2)	50.00'	18.04'	34.69'	39°40'17"	114°35'30"	33.93'	S 89°11'19"W
(C-3)	50.00'	24.67'	46.63'	52°31'20"	114°35'30"	44.25'	N 74°42'52"W
(C-4)	50.00'	7.40'	14.70'	16°50'29"	114°35'30"	14.64'	N 40°01'57"W
(C-5)	50.00'	8.11'	16.08'	18°25'48"	114°35'30"	16.01'	S 0°40'06"E
(C-6)	598.00'	42.58'	70.52'	80°48'22"	114°35'30"	64.82'	01°03'01"E
(C-7)	598.00'	140.48'	275.95'	26°26'23"	93°45'52"	273.51'	S 28°07'49"E
(C-8)	309.55'	73.24'	143.83'	26°37'23"	18°30'34"	142.54'	S 28°13'19"E
(C-9)	325.00'	13.78'	27.58'	04°51'29"	17°37'46"	27.35'	N 87°07'19"E
(C-10)	334.55'	30.18'	60.20'	10°18'39"	17°07'34"	60.12'	S 36°22'41"E
(C-11)	623.00'	16.05'	32.09'	2°57'03"	9°11'48"	32.08'	S 16°23'09"E
(C-12)	50.00'	48.87'	77.40'	88°41'27"	114°35'30"	69.90'	N 26°07'37"W
(C-13)	50.00'	24.42'	45.43'	52°03'21"	114°35'30"	43.88'	N 44°14'47"E
(C-14)	50.00'	21.24'	40.17'	46°01'54"	114°35'30"	39.10'	S 86°42'36"E
(C-15)	50.00'	24.10'	44.91'	51°27'32"	114°35'30"	43.41'	S 37°57'53"E
(C-16)	50.00'	29.90'	53.90'	61°45'46"	114°35'30"	51.33'	S 16°38'47"W
(C-17)	325.00'	12.13'	24.25'	4°16'28"	17°37'46"	24.24'	N 36°51'46"W
(C-18)	334.55'	21.10'	42.13'	7°25'41"	17°37'46"	42.11'	N 14°11'11"W
(C-19)	334.55'	15.90'	31.77'	5°26'26"	17°07'34"	31.76'	S 17°37'49"E
(C-20)	350.00'	80.02'	157.34'	25°45'23"	16°22'13"	158.01'	N 62°08'02"E
(C-21)	400.00'	74.84'	147.98'	21°11'46"	14°19'26"	147.13'	S 89°51'13"E
(C-22)	15.00'	27.39'	33.09'	122°34'44"	21°58'19"	26.31'	S 43°41'55"E
(C-23)	9.00'	13.99'	17.98'	114°29'36"	276°37'11"	15.14'	S 73°53'08"E

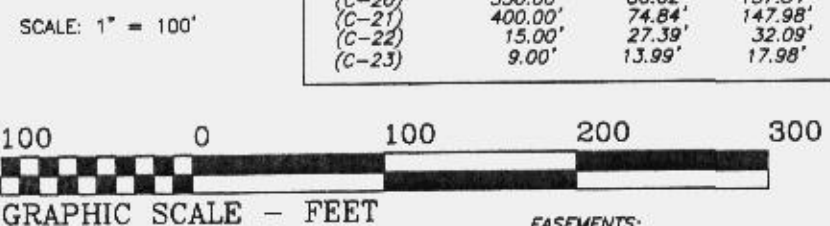

EASEMENTS:
Along the rear of all outside lots there shall be a two foot utility easement. A five foot utility easement shall be in all lots adjacent to another lot located along the adjacent lot lines. Along the front of all lots there shall be a five foot utility easement.

FEMA DESIGNATED FLOOD ZONE
The south western edge of the property is in the 100 year flood zone of the river.

Approval of this Plat shall be invalid unless the approved Plat for such Addition is recorded in the office of the County Clerk of Parker County, Texas, within six (6) months from the date of final approval by the Aledo Planning and Zoning Commission.

MIZELL LAND SURVEYING, INC.
117 John Street P.O. Box 1029
Aledo, TX 76008
817-441-6199 FAX: 817-441-6805

ACCT. NO: 13740
SCH. DIST: AL
CITY: AL
MAP NO: M-18

Replat
Lots 8-R & 9-R, Block 5 and Lots 41-R & 42-R, Block 1
Being a Revision of Lots 8 & 9, Block 5 and
Lots 41 & 42, Block 1
HOWARDS CROSSING
An Addition to the City of Aledo, Parker County, Texas
According to Plat Recorded in Plat Cabinet, Slide
Plat Records, Parker County, Texas.

Doc 00502878 BK Vol Pg
2175 1208
FILED IN PUBLIC RECORDS
ON THE 15th DAY OF DEC 2003
Document Number: 00502878
Amount: \$6.00
By Leslie Coufal

STATE OF TEXAS
COUNTY OF PARKER
I hereby certify that this instrument was filed on the date and time stamped hereon by me and was duly recorded in the volume and page of the stated records of Parker County as stamped hereon by me.

Dec 15, 2003

Jeanne Branson, County Clerk
Parker County