

DEDICATION

THE STATE OF TEXAS

COUNTY OF PARKER

KNOW ALL MEN BY THESE PRESENTS:

That Parker County Memorial Park Incorporated by E. V. Nordlund, its President, and Charles S. Shumaker, its Secretary, do hereby declare and dedicate the premises described in the accompanying plat and deed to the singular purpose of burial of human beings of the Caucasian race as authorized under the Statutes of the State of Texas, and by this Dedication particularly dedicate Blocks "C" and "D" as marked upon said map and plat - Blocks "A" and "B" with driveways and walks having been previously dedicated by a dedication heretofore made.

IN WITNESS WHEREOF, Parker County Memorial Park Incorporated has this date caused these presents to be signed and executed by E. V. Nordlund, its President, and Charles S. Shumaker, its secretary, and has caused its Seal to be hereto affixed, this the 2nd day of October 1961.

PARKER COUNTY MEMORIAL PARK INCORPORATED

By E. V. Nordlund, President

Charles S. Shumaker, Secretary.

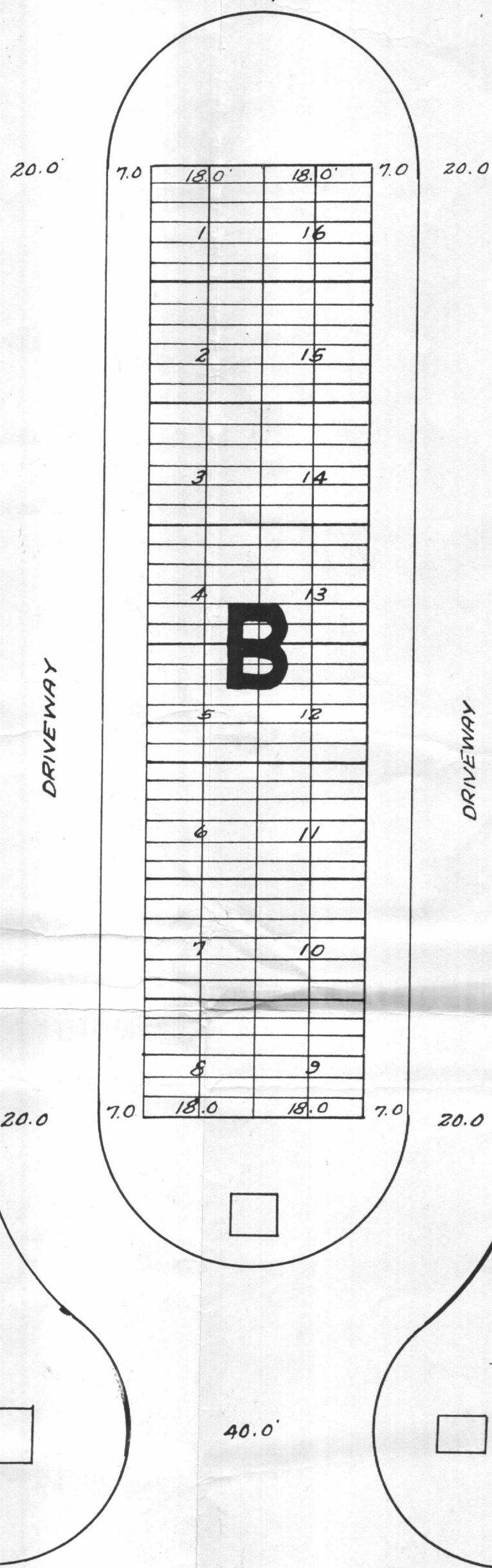
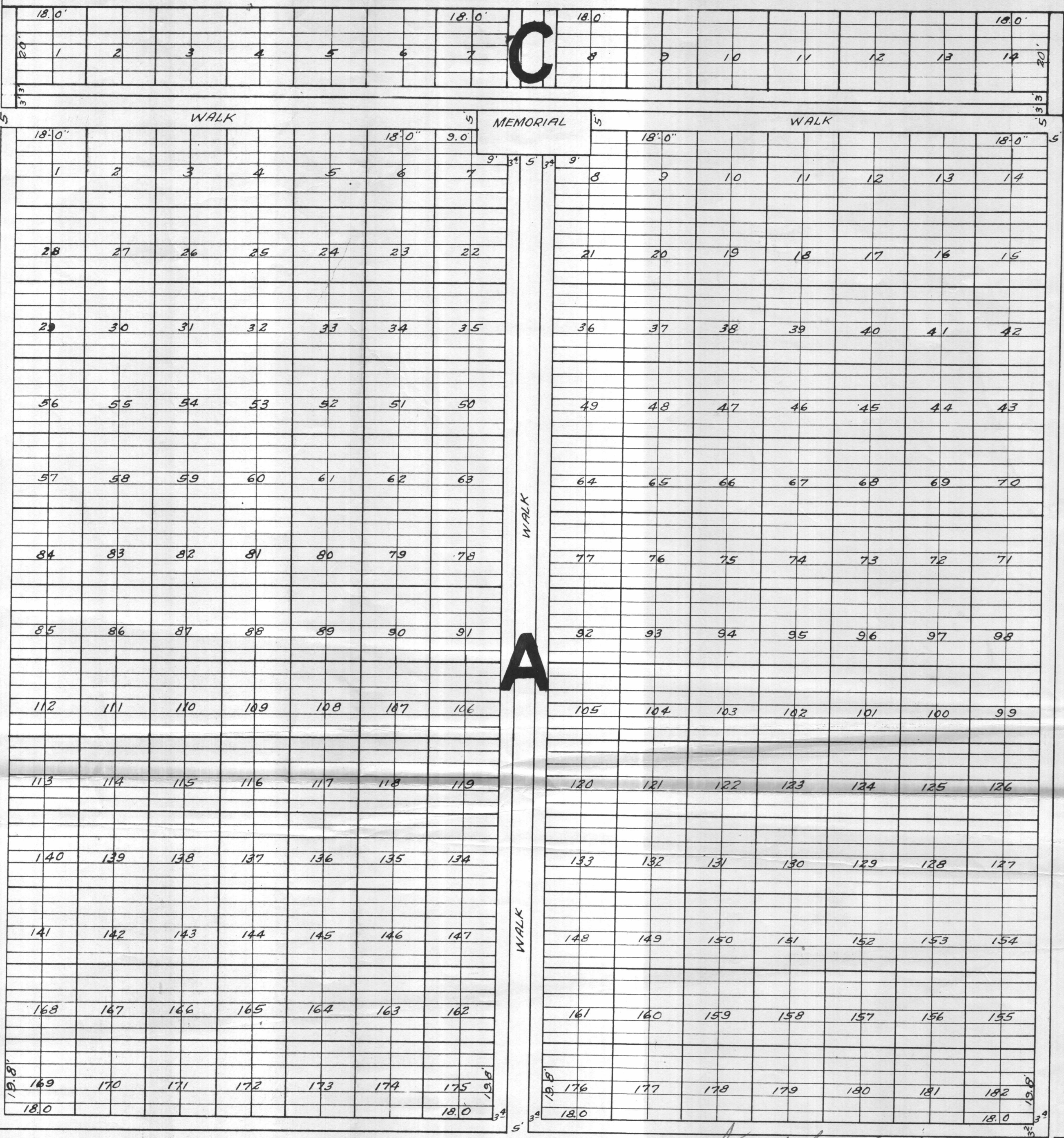
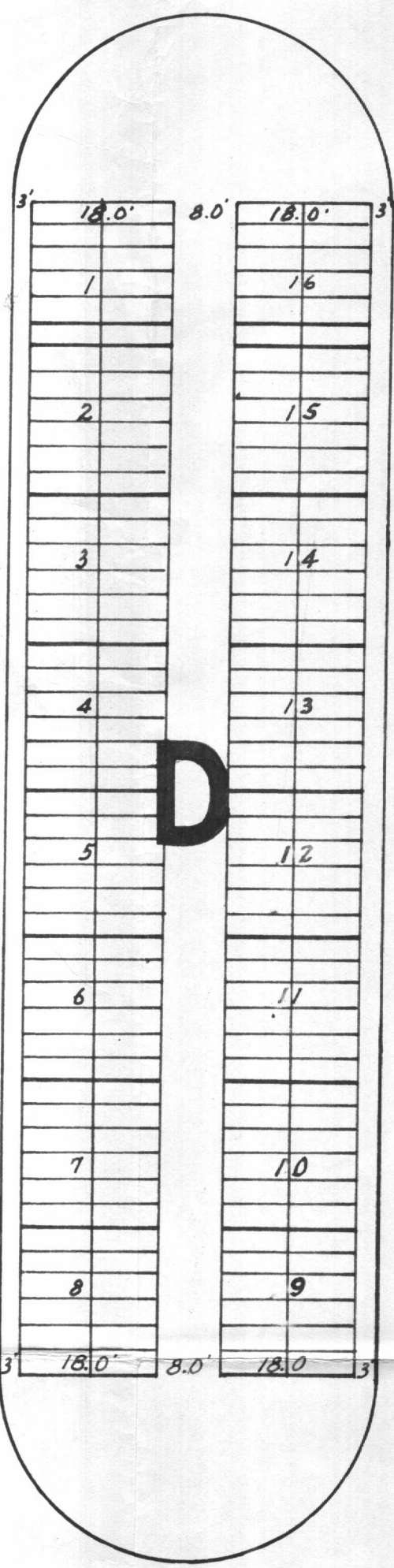

1	2
3	4
5	6
7	8
9	10
11	12

Plat of Tracts A, B, C & D
Parker County Memorial Park
A perpetual care cemetery
2 1/2 acres out of 24 acres of
the R. A. Kidwell Survey A-2016
Parker County, Texas
Parker County Memorial Park Incorporated in
Weatherford.

L. C. McCanlies, Registered Professional Engineer and County Surveyor.

Scale: 1" = 20'

Frank E. Glodoff - Co. Judge
Scott Moody

Louis Sulbert
McLaughlin

