

PARKS OF ALEDO,  
POINT VISTA, PHASE ONE  
CAB. D, SLIDE 689  
P.R.P.C.T.

JOHN SPARGER SURVEY  
ABSTRACT NO. 1230

REMAINDER  
POA LAND INVESTMENTS, LLC  
DOCUMENT No. 201524444  
D.R.P.C.T.

REMAINDER  
POA LAND INVESTMENTS, LLC  
DOCUMENT No. 201524444  
D.R.P.C.T.

REMAINDER  
POA LAND INVESTMENTS, LLC  
DOCUMENT No. 201524444  
D.R.P.C.T.

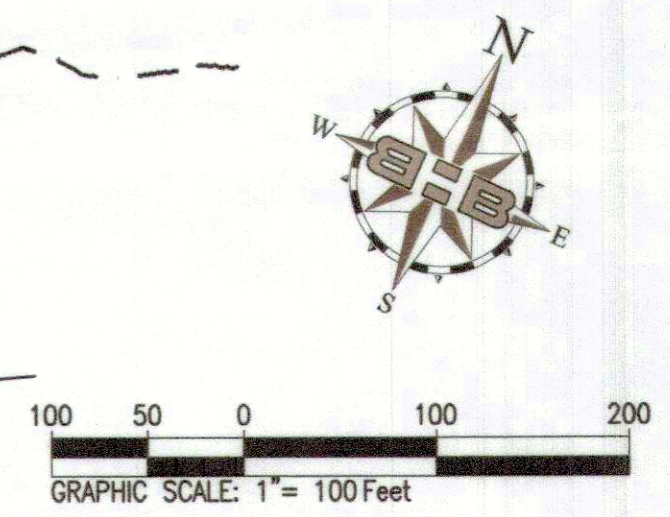

OPEN SPACE AREA TABLE			
LOT NO.	BLOCK NO.	AREA - SQ.FT.	AREA - ACRES
33X	C	2,500	0.057
17X	F	4,925	0.113
10X	F	5,000	0.115
42X	G	5,200	0.119
33X	G	5,200	0.119
47X	J	2,700	0.062
17X	J	2,700	0.062
1X	K	4,479	0.103
1X	L	124,731	2.863

**FINAL PLAT**  
**PARKS OF ALEDO,**  
**POINT VISTA,**  
**PHASE TWO**

Being a 58.821 acre tract of land situated in the  
John Sparger Survey, Abstract Number 1230 &  
the John G. Wray Survey, Abstract Number 1639  
City of Aledo, Parker County, Texas

**ZONED: PD R-2**  
**JUNE 2018**  
**SHEET 2 OF 4**

ACCT. NO.: 16071  
SCH. DIST.: 1-77  
CITY:  
MAP NO.:

21639.003.003.00      21230.001.007.00

This plat filed in Cabinet **E**, Slide **107**

**SURVEYOR:**  
**B.B. BAIRD, HAMPTON & BROWN, INC.**  
ENGINEERING & SURVEYING  
1901 Martin Drive, Ste. 100, Weatherford, TX 76086  
lwhitten@bbhinc.com      817-596-7575      www.bbhinc.com  
BHB Project #2017.801.017      TBPE Firm F-44      TBPLS Firm 10194146

**OWNER:**  
POA Land Investments, LLC  
311 University Drive, Suite 100  
Fort Worth, TX 76107

**LEGEND**  
BL.....Building Line  
BHB.....5/8" Capped Iron Rod Found Marked "BHB INC"  
D&U.E...Drainage & Utility Easement  
F.M.E.....2.5' Fence Maintenance Easement  
U.E.....Utility Easement