

MATCHLINE SHEET No. 2

CALLLED 15.52 ACRES
BOYCE KEVIN HAMILTON AND KENA LYNN HAMILTON
INST. NO. 201505275
O.P.R.P.C.T.

RIGHT-OF-WAY DEDICATION
1.358 ACRE
(59,167 SQ. FT.)

PUBLIC RIGHT-OF-WAY EASEMENT
CAB. D. SLIDE 282
P.R.P.C.T.

MAG NAIL SET

RIGHT-OF-WAY DEDICATION
1.358 ACRE
(59,167 SQ. FT.)

MAG NAIL SET

P.O.B.

CALLLED 3.043 ACRES
MARK WILSON AND MELINDA WILSON
INST. NO. 201610504
O.P.R.P.C.T.

5.0 ACRES
JOHN DANIEL DENBOW
INST. NO. 201709856
O.P.R.P.C.T.

5.0 ACRES
JOHN DANIEL DENBOW
INST. NO. 201709856
O.P.R.P.C.T.

CALLLED 72.688 ACRES
TOMMY BULLARD AND WIFE, JOHANNA BULLARD
VOL. 1640, PG. 997
D.R.P.C.T.

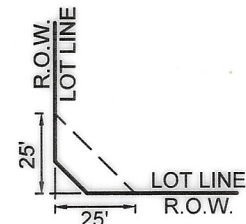

DETAIL - A
VISIBILITY, ACCESS,
MAINTENANCE
EASEMENT

SEE SHEET No.2 FOR
LINE & CURVE TABLES
AND GENERAL NOTES

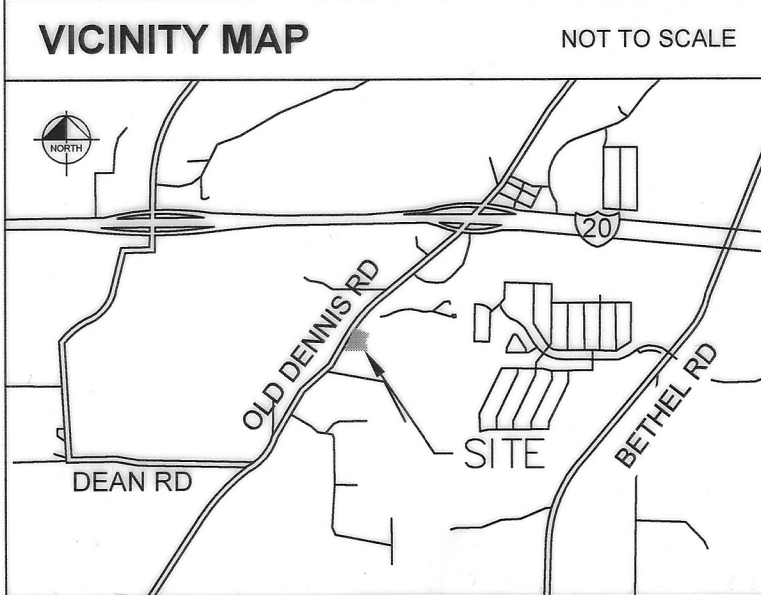

LEGEND	
D.R.P.C.T.	DEED RECORDS OF PARKER COUNTY, TEXAS
P.R.P.C.T.	PLAT RECORDS OF PARKER COUNTY, TEXAS
IRF	IRON ROD FOUND
IRFC	IRON ROD WITH CAP FOUND
IRSC	IRON ROD WITH "KHA" CAP SET
VOL.	VOLUME
PG.	PAGE
INST.	INSTRUMENT No.
B.L.	BUILDING LINE
DE	DRAINAGE EASEMENT
SSE	SANITARY SEWER EASEMENT
UE	UTILITY EASEMENT
WME	WALL MAINTENANCE EASEMENT
VAM	VISIBILITY, ACCESS, & MAINTENANCE ESMT.
MIN.FFE	MINIMUM FINISHED FLOOR ELEVATION
	STREET NAME CHANGE

LINE TYPE LEGEND	
	BOUNDARY LINE
	EASEMENT LINE
	BUILDING LINE

NORTH

GRAPHIC SCALE IN FEET

1" = 60' @ 18X24

F156

FINAL PLAT RANCHES WEST PHASE 3

BLOCK E, LOTS 10-19;
BLOCK G, LOTS 27-37, 38X, 39-54 & 55X;
BLOCK P, LOT 1-23;

60 RESIDENTIAL LOTS
2 OPEN SPACE LOTS

15.115 ACRES OUT OF THE JOHN DAVIS, A-349
CITY OF WEATHERFORD, PARKER COUNTY, TEXAS

OWNER:
D.R. Horton - Texas, Ltd.
6751 North Freeway
Fort Worth, Texas 76131
P (817) 230-0800
Contact: Justin Bosworth

APPLICANT:
Kimley-Horn and Associates, Inc.
6160 Warren Pkwy., Suite 210
Frisco, TX 75335
Ph: 972.335.3580
Contact: Rob Myers, PE

**16554
WE
CWE
G-17**

Kimley»Horn

6160 Warren Parkway, Suite 210
Frisco, Texas 75034

Tel. No. (972) 335-3580
FIRM # 10193822

Scale	Drawn by	Checked by	Date	Project No.	Sheet No.
1" = 60'	CDS	KHA	JAN. 2022	068517096	2 OF 4