

JONES ESTATES  
PLAT CABINET E, SLIDE 11

DONALD M. UMPHENOUR  
DOC# 201523675

ROBERT COOK  
DOC# 201727536

CHARLES W. FORETCH  
VOLUME 1046, PAGE 1072

1944.65

1954.93

REMAINDER  
MARK ALAN COLEMAN  
DOC# 201702951

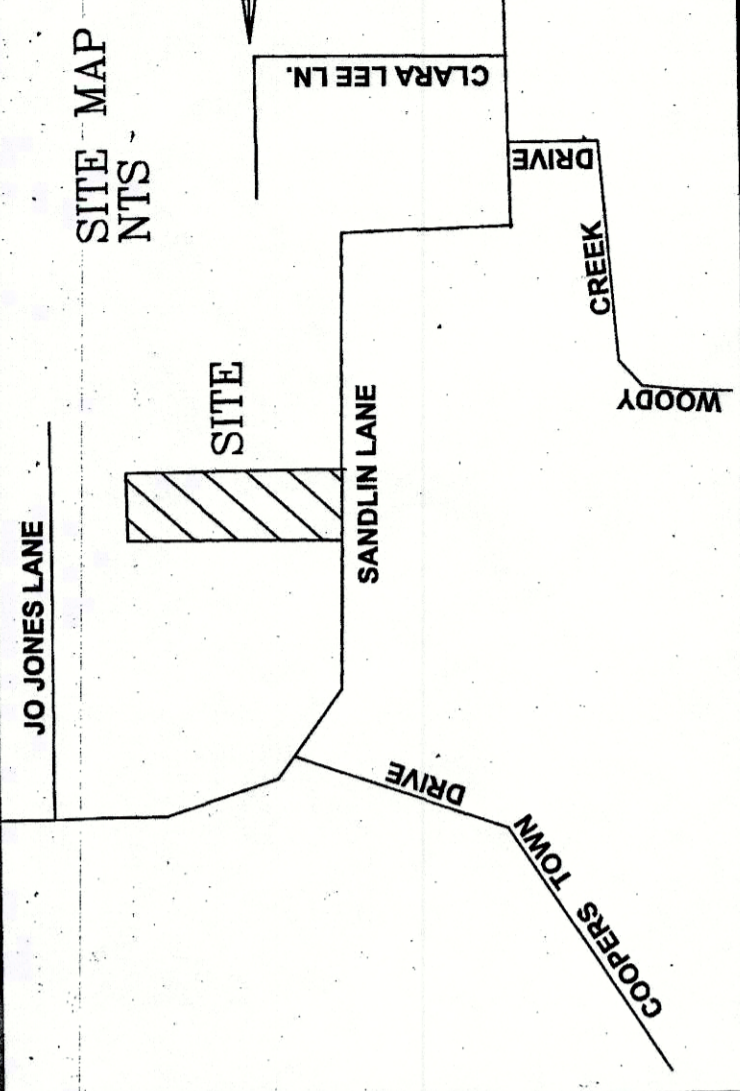

NOTICE: Selling a portion of this addition by metes and bounds is a violation of county regulations and state law, and is subject to fines and other penalties.

WATER Walnut Creek Special Utility District  
1155 W. HIGHWAY No. 1999 817 523 4463

WASTEWATER: Individual Private Septic System

201908125 PLAT Total Pages: 3

Surveyor is not responsible for locations of Underground utilities. Contact 811 for locations of all underground utilities/gas lines before digging, trenching, excavation or building.

NOTE: ACCORDING TO THE FEDERAL EMERGENCY MANAGEMENT AGENCY (FEMA) AND FEDERAL INSURANCE ADMINISTRATION FLOOD INSURANCE RATE MAP COMMUNITY PANEL NUMBER 4803010175 E. EFFECTIVE DATE: SEPTEMBER 21, 2005. THIS PROPERTY IS NOT IN A 100 YEAR FLOOD HAZARD AREA.

NOTE: BEARING BASIS IS TEXAS STATE PLANE SYSTEM, NORTH CENTRAL ZONE, NAD 83

THE STATE OF TEXAS  
COUNTY OF PARKER

I hereby certify that this plat is true and correct and was prepared from an actual survey of the property made under my supervision on the ground.

*David Harlan, Jr.*  
David Harlan, Jr.  
Registered Professional Land Surveyor, No. 2074



November 2018

CENTER ROAD DATA

C1	L=84.68° R=600.0'
	N 00°50'47" W 84.61'
C2	L=97.20° R=1000.0'
	N 00°24'43" E 97.17'
C3	L=368.45° R=1000.0'
	N 08°10'57" E 368.37'
C4	L=325.29° R=800.0'
	N 05°37'06" E 323.05'
C5	L=309.76° R=1002.14'
	N 02°50'05" E 308.52'

\$400

FINAL PLAT  
LOTS 1 THROUGH 21  
SPRINGTOWN HEIGHTS @ COLEMAN BEND  
AN ADDITION IN PARKER COUNTY, TEXAS  
Being 23.83 acres situated in and being  
a portion of the Thomas Cassidy Survey  
Abstract No. 273, Parker County, Texas

ACCT. NO.: 1814  
SCH. DIST.: SP  
CITY: R-7  
MAP NO.:

NOTE: LINES PLOTTED FROM MARKERS FOUND ON THE GROUND AND ASSUMED DIRECTIONS AND MAY NOT BE ACTUAL LOCATIONS OF LINES.

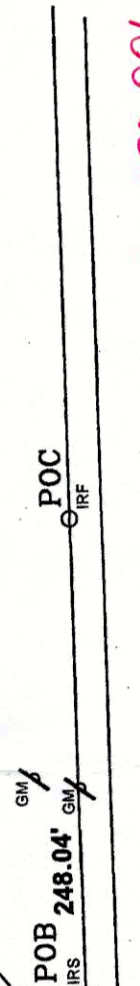

20273.002.001.00

SCALE: 1" = 100'

HARLAN LAND SURVEYING, INC.  
106 EUREKA STREET  
WEATHERFORD, TX 75086  
METRO(817)596-9700-(617)599-0880  
FAX: METRO(817) 341-2833  
FIRM# 10088500

SANDLIN LANE  
(COUNTY ROAD)

REF 1/2" IRON ROD UNLESS NOTED  
RES 1/8" IRON ROD (HARLAN, 2074 "CAP")

SHEET ONE OF TWO

Cabinet/Instrument# 267 Slide