

F.M. HIGHWAY NO. 1542

STATE OF TEXAS  
COUNTY OF PARKER

Whereas we, James C. Thomason, Hendrix Springfield, and La Junta Baptist Church, being the owners of; the following described tract;

Description for a tract of land out of the T. & P. RR. Co. Survey, Abstract No. 1381, Parker County, Texas;

BEGINNING at a steel rod in the west line of F. M. Highway No. 1542, said point being West, 50.00 feet and N. 00 deg. 38 min. 44 sec. E., 1090.90 feet from the most southerly southeast corner of said T. & P. RR. Co. Survey, Abstract No. 1381;

THENCE N. 86 deg. 12 min. 30 sec. W., 1399.66 feet to a steel rod;

THENCE N. 03 deg. 36 min. 19 sec. W., 345.95 feet to a steel rod;

THENCE N. 89 deg. 33. min. 23 sec. E., 1422.30 feet to a steel rod in the west line of said Highway;

THENCE S. 00 deg. 37 min. 36 sec. W., with the west line of said highway, 448.93 feet to the POINT OF BEGINNING and containing 12.84 acres of land.

NOW THEREFORE, KNOW ALL MEN BY THESE PRESENTS:

That we, James C. Thomason, Hendrix Springfield, and La Junta Baptist Church, do hereby adopt this plat designating the hereinabove described real property as SUMMERFIELDS II, an Addition to the City of Reno, Parker County, Texas, and do hereby dedicate to the public's use forever, the straits and/or easements shown thereon.

*James C. Thomason*  
James C. Thomason  
*Hendrix Springfield*  
Hendrix Springfield  
*Curtis F. Elton*  
Curtis F. Elton  
*Darryl L. Altom*  
Darryl L. Altom  
*Michael A. Nettles*  
Michael A. Nettles  
La Junta Baptist Church

185421  
PCA-008  
RECEIVED AND FILED  
FOR RECORD  
9:45 O'Clock P.M.  
DEC 21 1989  
CARRIE REED, Co. Clerk  
PARKER COUNTY, TEXAS  
By *ja* Deputy

STATE OF TEXAS COUNTY OF PARKER  
I hereby certify that this instrument was filed on the date and time stamped hereon by me and was duly recorded in the volume and page of the named records of Parker County as stamped hereon by me.  
RECORDED DEC 21 1989  
SEAL  
Carrie Reed  
County Clerk, Parker County, Tex.

STATE OF TEXAS  
COUNTY OF PARKER

This instrument was acknowledged before me on the 30 day of October, 1989, by James C. Thomason, Hendrix Springfield, and trustees for La Junta Baptist Church.

*Jane Vaugh*  
Notary Public  
7-30-91  
My Commission Expires

CITY OF RENO, TEXAS  
APPROVED *November 6, 1989* DATE  
BY MAYOR *F. E. Pugh*  
BY SECRETARY *Kayna Meeks*

PLAT OF  
**SUMMERFIELDS II**  
AN ADDITION TO THE CITY OF RENO,  
PARKER COUNTY, TEXAS.  
BEING 12.84 ACRES OUT OF THE T & P.  
R.R. CO. SURVEY, ABSTRACT NO.  
1381, PARKER COUNTY, TEXAS.

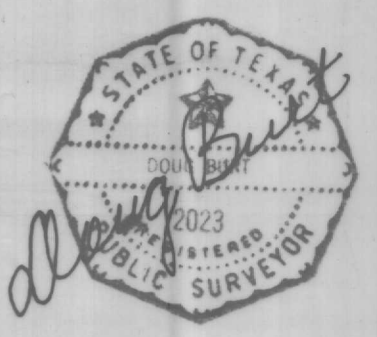

I certify that this is a true and accurate representation of this survey as made on the ground.  
12/MAY/89

SCALE: 1"=100'

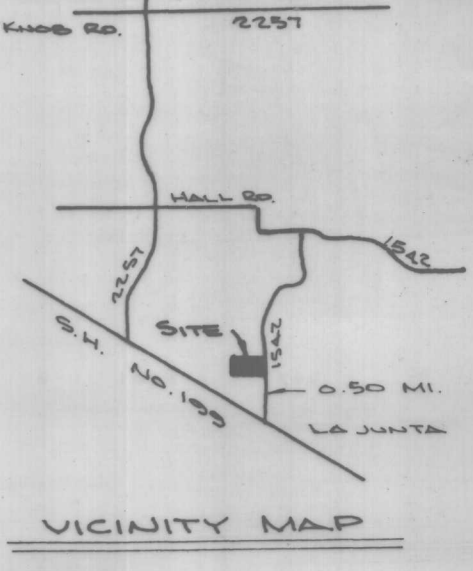

DOUG BURT SURVEYING  
P.O. BOX 1233  
SPRINGTOWN, TEXAS  
523-5641