

CURVE DATA

CURVE	RADIUS	ARC LENGTH	CHORD LENGTH	CHORD BEARING
C1	330.00'	75.11'	74.95'	S 87°29'26" W
C2	30.00'	47.12'	42.43'	N 54°01'48" W
C3	330.00'	319.13'	306.83'	N 58°17'06" W
C4	330.00'	2.59'	2.59'	S 59°38'20" W
C5	330.00'	208.38'	204.94'	S 77°57'13" W
C6	80.00'	107.95'	99.95'	S 69°09'04" W
C7	330.00'	13.97'	13.97'	N 82°44'39" W
C8	80.00'	50.73'	49.88'	N 54°01'31" W
C9	80.00'	101.42'	94.76'	N 00°27'30" E
C10	80.00'	86.95'	82.73'	S 67°54'46" W
C11	80.00'	94.10'	88.77'	N 47°15'12" W
C12	270.00'	152.57'	150.55'	S 82°16'49" W
C13	270.00'	31.47'	31.45'	S 62°45'11" W
C14	30.00'	47.12'	42.43'	N 75°35'10" W
C15	270.00'	46.59'	46.53'	S 54°28'16" W
C16	80.00'	115.50'	105.73'	S 10°46'41" E
C17	270.00'	124.04'	122.96'	S 36°21'59" W
C18	80.00'	70.70'	68.43'	S 55°54'11" W
C19	80.00'	54.15'	53.12'	N 79°23'14" W
C20	80.00'	86.07'	81.98'	N 79°10'28" W
C21	80.00'	100.16'	93.75'	S 37°30'59" W
C22	80.00'	14.10'	14.08'	S 78°26'00" W
C23	330.00'	77.84'	77.66'	S 28°35'33" W
C24	330.00'	103.76'	103.34'	S 44°21'09" W
C25	330.00'	34.87'	34.85'	S 29°29'15" W
C26	80.00'	106.25'	98.61'	S 29°29'15" W
C27	80.00'	83.78'	80.00'	N 82°27'41" W
C28	80.00'	125.45'	112.99'	N 07°32'06" W
C29	30.00'	47.12'	42.43'	N 35°58'12" E
C30	270.00'	322.53'	303.70'	S 64°48'29" E

CENTERLINE CURVE DATA

CURVE	RADIUS	ARC LENGTH	CHORD LENGTH	CHORD BEARING
CL1	300.00'	358.37'	337.44'	S 64°48'29" E
CL2	300.00'	204.49'	200.55'	N 78°56'28" E
CL3	300.00'	252.63'	245.24'	N 35°17'21" E

LINE DATA

LINE	BEARING	DISTANCE
L1	N 29°57'58" W	80.80'
L2	N 31°19'29" W	182.61'
L3	N 30°30'48" W	190.86'
L4	S 77°04'56" W	134.52'
L5	N 09°04'48" W	206.35'
L6	N 07°43'32" W	164.10'
L7	N 31°36'09" E	197.80'
L8	N 59°28'20" E	83.01'
L9	S 30°35'05" E	241.61'
L10	N 59°21'16" E	179.94'
L11	N 30°33'55" W	241.24'
L12	N 59°27'43" E	59.93'
L13	S 30°36'36" E	241.28'
L14	S 30°33'42" E	149.46'
L15	N 30°32'56" W	391.88'
L16	N 59°34'21" E	60.13'
L17	S 30°56'14" W	88.72'
L18	S 80°58'12" W	70.00'
L19	N 81°31'53" W	12.63'
L20	N 81°31'53" W	12.63'
L21	N 80°58'12" E	70.00'
L22	S 81°31'53" W	86.79'
L23	N 11°09'52" E	15.15'
L24	N 30°35'10" W	9.90'

ROAD FOOTAGE DATA

RIO GRANDE WAY	294.54'
MERRIAM COURT	610.67'

ACCT. NO.: 18541
 SCH. DIST.: WE
 CITY: H19+H20
 MAP NO.:

20546.007.000.00
 20924.008.001.50
 20924.008.006.00

FINAL PLAT OF LOTS 1-35, BLOCK 1 TURKEY TRACK RANCH

77.613 ACRES OF LAND OUT OF THE W. GREEN SURVEY, ABSTRACT NO. 546 AND THE W. MANN SURVEY, ABSTRACT NO. 924 PARKER COUNTY, TEXAS. MAY 2017

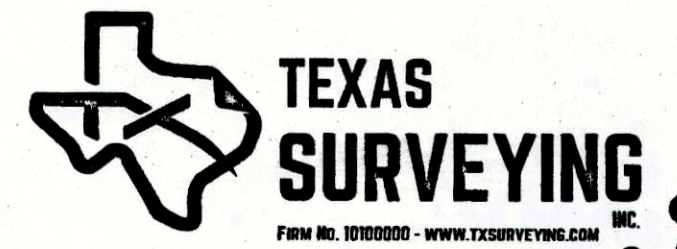
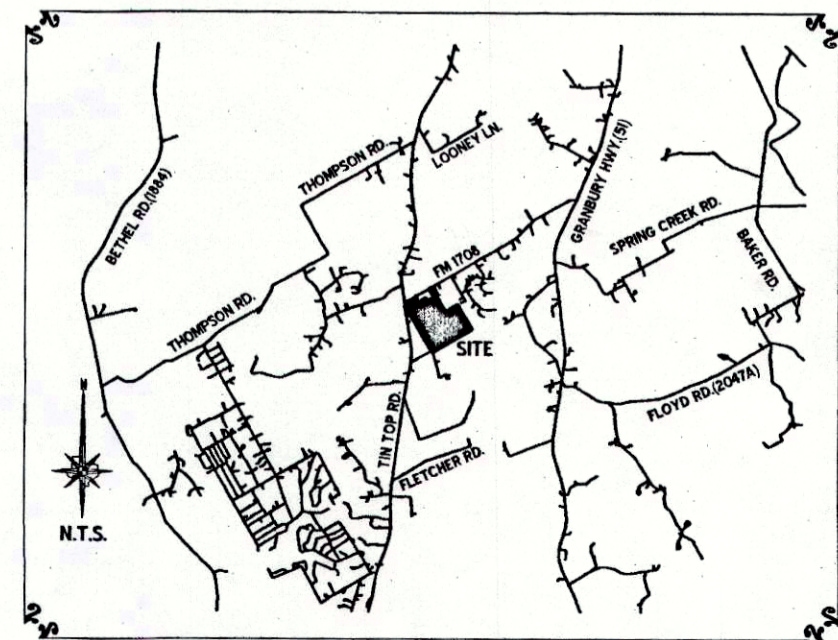

SURVEYOR: MICAH HAMILTON, R.P.L.S.
 110 PALO PINTO WEATHERFORD, TEXAS, 76086
 817-594-0400

OWNER/DEVELOPER: DEREK OSBURN
 1501 BUCKNER ROAD LIPAN, TX 76445

T. PHILLIPS SURVEY ABSTRACT NO. 1082

J. CAMPBELL SURVEY ABSTRACT NO. 313

D754

JN170321P

