

PLAT OF
 LOTS 5-A, 5-B, 5-C AND 6-A, BLOCK-2
 BEING A REVISION OF THE CIRCLE R
 COUNTRY HOMES SUBDIVISION OF LOTS
 5 AND 6, BLOCK-2, ARMADILLO HILLS
 ESTATES.

PARKER COUNTY, TEXAS

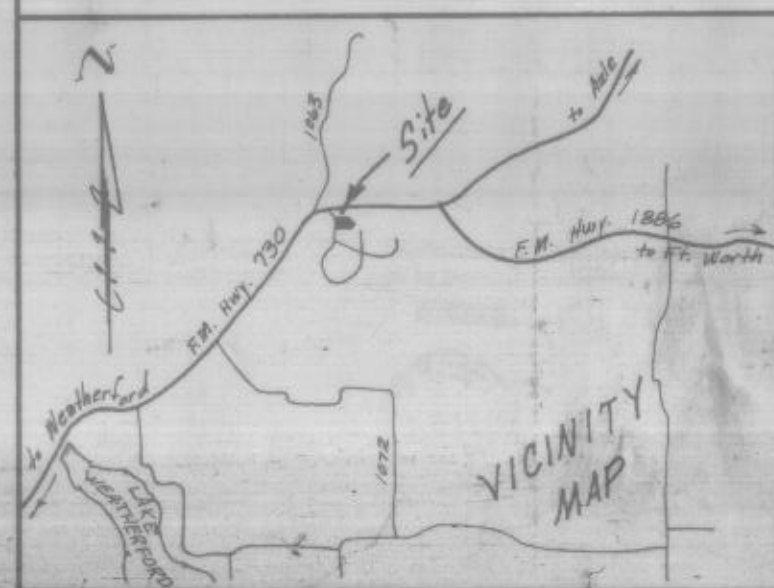

RECEIVED AND FILED
 FOR RECORD
 2:00 O'clock P.
 APR 22 1991
 CARRIE REED, Co. Clerk
 PARKER COUNTY, TEXAS

204898
 PCA 719

STATE OF TEXAS
 COUNTY OF PARKER

WHEREAS we Ronny B. Newton and wife Deanna Newton are the owners of that part of Lot 5, Block 2, ARMADILLO HILLS ESTATES as recorded in Vol. 1154, Page 608, D.R.P.C.T. and we Donald D. Voochies and wife Susan M. Voochies the owners of that part of Lot 5, Block 2, ARMADILLO HILLS ESTATES as recorded in Vol. 1355, Page 1381, D.R.P.C.T. and I Don Rutland the owner of all of Lot 5, Block 2, except that part described above and all of Lot 6, Block 2, ARMADILLO HILLS ESTATES and also the developer of the Revised Plat of Lots 5 and 6, Block 2, ARMADILLO HILLS Estates known as CIRCLE R COUNTRY HOMES, a Subdivision in Parker County, Texas as recorded in Vol. 361A, Page 77, Plat Records, Parker County, Texas DO HEREBY ADOPT THE FOREGOING PLAT TO BE KNOWN AS Lots 5-A, 5-B, 5-C and 6-A, Block 2, being a revision of the CIRCLE R COUNTRY HOMES SUBDIVISION of Lots 5 and 6, Block 2, Armadillo Hills Estates, Parker County, Texas, and do hereby dedicate to the public use forever the streets and easements shown thereon.

IN WITNESS WHEREOF THIS DEDICATION IS EXECUTED.
 this the 18th day of March, 1991.

Ronny B. Newton Ronny B. Newton
Deanna Newton Deanna Newton
Don Rutland Don Rutland
Donald D. Voochies Donald D. Voochies
Susan M. Voochies Susan M. Voochies

THE STATE OF TEXAS
 COUNTY OF PARKER

BEFORE ME, THE UNDERSIGNED, A Notary Public, in and for the State of Texas on this day personally appeared *Don Rutland* and *Ronny B. Newton*, known to me to be the person(s) whose name(s) is/are subscribed to on the foregoing instrument and acknowledged to me that they executed the same for the purposes and considerations therein expressed.

GIVEN UNDER MY HAND AND SEAL OF OFFICE this the 18 day of March, 1991.

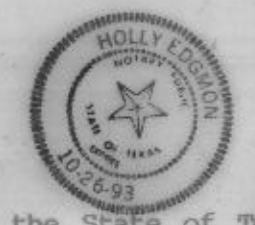

Holly Edgmon
 Notary Public State of Texas
 Printed Name: HOLLY EDGMON
 Commission Expires: 10-26-93

THE STATE OF TEXAS
 COUNTY OF PARKER

BEFORE ME, THE UNDERSIGNED, A Notary Public, in and for the State of Texas on this day personally appeared *Deanna Newton* and *Ronny B. Newton*, known to me to be the person(s) whose name(s) is/are subscribed to on the foregoing instrument and acknowledged to me that they executed the same for the purposes and considerations therein expressed.

GIVEN UNDER MY HAND AND SEAL OF OFFICE this the 18 day of March, 1991.



Holly Edgmon
 Notary Public State of Texas
 Printed Name: HOLLY EDGMON
 Commission Expires: 10-26-93

THE STATE OF TEXAS
 COUNTY OF PARKER

BEFORE ME, THE UNDERSIGNED, A Notary Public, in and for the State of Texas on this day personally appeared *Donald D. Voochies* and *Susan M. Voochies*, known to me to be the person(s) whose name(s) is/are subscribed to on the foregoing instrument and acknowledged to me that they executed the same for the purposes and considerations therein expressed.

GIVEN UNDER MY HAND AND SEAL OF OFFICE this the 18 day of March, 1991.



Holly Edgmon
 Notary Public State of Texas
 Printed Name: HOLLY EDGMON
 Commission Expires: 10-26-93

APPROVED BY THE COUNTY COMMISSIONERS this the 15th day of April, 1991.

Accepted by: *James E. Waring*
 COUNTY JUDGE
Waymon Wright
Mark Doble

THE STATE OF TEXAS
 COUNTY OF PARKER

I, Carrie Reed, Clerk of the County Court, in and for said County, do hereby certify that the foregoing plat with its certificate of authentication, was filed for record in my office the ___ day of ___, 1991, at ___ o'clock ___ m. and duly recorded in the ___ day of ___, 1991, at ___ o'clock ___ m. in ___ Records of said County in Plat Cabinet ___, Slide ___.

In testimony whereof, Witness my hand and official seal of office, this the ___ day of ___, 1991.

Carrie Reed
 Clerk County Court
 Parker County, Texas
 By: Deputy



HUGHES AND ASSOCIATES
 LAND SURVEYING
 CIVIL ENGINEERING
 LAND PLANNING
 111 E. COLUMBIA, SUITE E WEATHERFORD, TEXAS
 OFFICE 524-5274 OR 441-7819 HOME 524-2169

Tom Hughes
 I certify that this map was prepared from field notes of an actual survey made by me or under my supervision and to the best of my knowledge and belief represents said survey.
 Date 3/11/91 No. 14868