

PCB 733

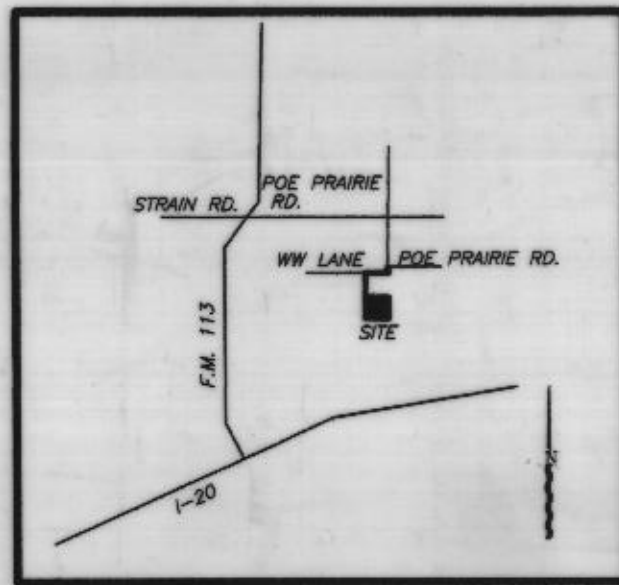

VICINITY MAP
NTS

ROBERT KUBIAK
AND WIFE
SHERRY KUBIAK
V. 1892, P. 285

ROBERT W. EDWARDS
AND
KATHI EDWARDS
V. 1890, P. 1691

OWNER/DEVELOPER
Jim Martin
4086 I-20 Service Rd. South
Willow Park, Texas 76087
817-341-4242

GREG EDWARDS
AND WIFE
JENNIFER EDWARDS
V. 1873, P. 347

ANGIUS M. POE SURVEY
ABST. NO. 1059

LUMAR DEVELOPMENT, INC.
V. 1854, P. 1078

T. & P. RR. CO. SURVEY
ABST. NO. 1535

SCALE: 1" = 200'

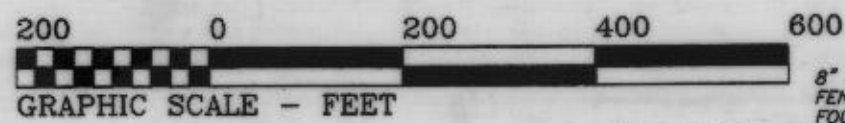

DAN L. WURST
AND
BARBARA J. DALTON
V. 1639, P. 297

W.W. WHITE SURVEY
ABST. NO. 2776

FRANK E. JONES
AND WIFE
PEGGY J. JONES
V. 1596, P. 1196

THOMAS B. PIGG SURVEY
ABST. NO. 2848

DOYLE D. GILBERT
V. 1711, P. 1081

Andrew E. Stevens
ANDREW E. STEVENS
REGISTERED PROFESSIONAL LAND SURVEYOR
TEXAS REGISTRATION NO. 5395
MAY 29, 2002



I hereby certify that this plat was prepared
from an actual on the ground survey
made under my supervision in May, 2002.

Final Plat
Lots 1, 2 and 3
SANDSTONE RIDGE
Phase I

Being 36.611 acres situated in the
T. & P. RR. CO. SURVEY, Abst. No. 1535
and the
ANGIUS M. POE SURVEY, Abst. No. 1059
Parker County, Texas

Notes:
To the best of my knowledge this site does not
lie within any municipalities extra territorial
jurisdiction.

Capped "Stevens Surveying" 1/2" irons set at
all corners unless otherwise noted.

According to the U.S. Department of Housing
and Urban Development Federal Insurance
Administration Flood Insurance Rate Map
Community Panel Number 480 520 0175 B Effective
September 27, 1991 this property does not lie within
a 100 year flood hazard area.

Doc 00458093 Bk OR Vol 2043 Pg 978

FILED AND RECORDED
OFFICIAL PUBLIC RECORDS
On: Sep 25, 2002 at 10:37A

Document Number: 00458093
Amount: \$6.00

By
Leann Franklin

STATE OF TEXAS COUNTY OF PARKER
I hereby certify that this instrument was
filed on the date and time stamped hereon by me
and was duly recorded in the volume and page
of the named records of Parker County
as stamped hereon by me.

Sep 25, 2002

JEROME BRANSON, COUNTY CLERK
PARKER COUNTY

PC-B-733