

CARTER SURVEYING
 & MAPPING
 APRIL 2009
 WEATHERFORD, PARKER COUNTY, TEXAS
 AN ADDITION TO THE CITY OF
 CARTER'S ADDITION
 BLOCK 18,
 LOT 16R,
 REPEAT

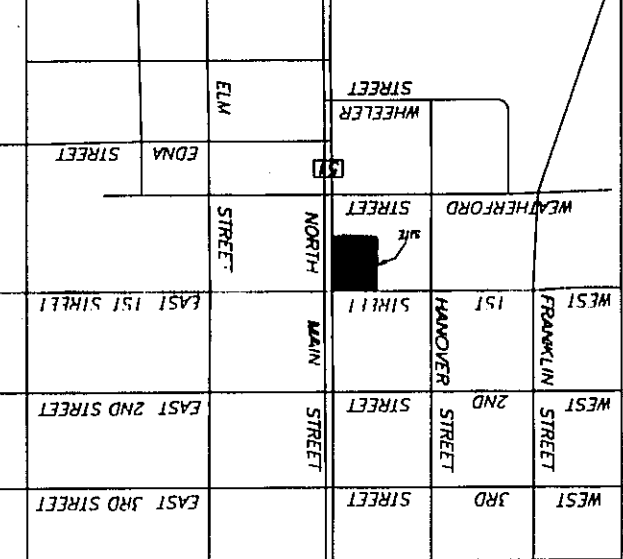

Doc# 72933 Fees: \$66.00
 12/07/2008 2:37PM Pages 1
 Filed in Official Records of
 PARKER COUNTY, TEXAS

ACCT. NO.: 11020
 SCH. DIST.: WE
 CITY: WE
 MAP NO.: H-14



BEFORE ME, the undersigned authority, on this day personally appeared Mike Martin, known to me by the person whose name is subscribed to the above and foregoing instrument, and acknowledged to me that he executed the same for the purposes and consideration expressed and in the capacity therein stated.
 GIVEN UNDER MY HAND AND SEAL OF OFFICE on this the 30th day of November, 2009.
Patricia S. Carter
 Notary Public in and for the State of Texas

STATE OF TEXAS
 COUNTY OF PARKER

SURVEYOR'S CERTIFICATE
 THIS IS TO CERTIFY THAT I, PATRICK CARTER, A REGISTERED PROFESSIONAL LAND SURVEYOR OF THE STATE OF TEXAS, DO CERTIFY THAT THIS PLAT REPRESENTS AN ACTUAL ON THE GROUND SURVEY, AND THAT ALL CORNER MARKINGS SET WERE PROPERLY PLACED IN ACCORDANCE WITH THE SUBMISSION ORDINANCE OF THE CITY OF WEATHERFORD. THIS PLAT CORRECTLY REPRESENTS THAT SURVEY MADE BY ME OR UNDER MY DIRECT SUPERVISION.

SURVEYOR'S CERTIFICATE
 PATRICK CARTER, REGISTERED PROFESSIONAL LAND SURVEYOR NO. 5691, 817-594-0400 - JWB0230-PLAT

STATE OF TEXAS
 COUNTY OF PARKER

BEFORE ME, the undersigned authority, on this day personally appeared Mike Martin, known to me by the person whose name is subscribed to the above and foregoing instrument, and acknowledged to me that he executed the same for the purposes and consideration expressed and in the capacity therein stated.
 GIVEN UNDER MY HAND AND SEAL OF OFFICE on this the 30th day of November, 2009.
Patricia S. Carter
 Notary Public in and for the State of Texas

STATE OF TEXAS
 COUNTY OF PARKER

STATEMENT ACKNOWLEDGING EASEMENTS:
 We do hereby waive all claims for damages against the City occasioned by the establishment of grades or the alterations of the surface of any portion of the existing streets and alleys, or natural contours, to conform to the grades established in the subdivision.
 Utility easements may also be used for the mutual use and accommodation of all public utilities, said use by public utilities being subordinate to the public use and the City of Weatherford. The City of Weatherford and public utility entities shall have the right to remove and keep removed all or parts of any building, fences, trees, shrubs, or other improvements or growths which may in any way endanger or interfere with the construction, maintenance, or efficiency of their respective systems in said easement. The City of Weatherford and public utility entities shall at all times have the full right of ingress and egress to or from their respective easements, without the necessity of any time procuring permission from anyone.

STATEMENT ACKNOWLEDGING V.A.M. EASEMENTS:
 The area or areas shown on the plat as "V.A.M." (Visibility, Access and Maintenance) Easement(s) are hereby given and granted to the City, its successors and assigns, as an easement to provide visibility, right of access for maintenance upon and across said V.A.M. Easement. The City shall have the right but not the obligation to maintain any and all landscaping within the V.A.M. Easement. Should the City exercise this maintenance right, then it shall be permitted to remove and dispose of any and all landscaping improvements, including without limitation, trees, shrubs, flowers, ground cover and bushes. The City may withhold maintenance responsibility for the V.A.M. Easement until the ultimate owners. No building, fence, shrub, tree or other improvements or growths, which in any way may endanger or interfere with the visibility, shall be constructed in, over or across the V.A.M. Easement and to remove any obstruction thereon. The City, its successors, assigns or agents shall have the right to enter upon the V.A.M. Easement or to remove any part thereof for the purposes and with all rights and privileges set forth herein.

SPECIAL NOTICE:
 Setting a portion of this addition by metes and bounds is a violation of Ordinance and State law, and is subject to fines and withholding of utilities and building permits.

FLOOD HAZARD ZONE:
 F.I.R.M. Community Panel #8357C0270E dated September 26, 2008. This tract does not appear to be in a flood hazard zone according to the SPECIAL NOTES:
 This tract appears to be currently Zoned I - Interstate District.

STATE OF TEXAS
 COUNTY OF PARKER

BEFORE ME, the undersigned authority, on this day personally appeared Mike Martin, known to me by the person whose name is subscribed to the above and foregoing instrument, and acknowledged to me that he executed the same for the purposes and consideration expressed and in the capacity therein stated.
 GIVEN UNDER MY HAND AND SEAL OF OFFICE on this the 30th day of November, 2009.
Patricia S. Carter
 Notary Public in and for the State of Texas

STATE OF TEXAS
 COUNTY OF PARKER

STATEMENT ACKNOWLEDGING V.A.M. EASEMENTS:
 The area or areas shown on the plat as "V.A.M." (Visibility, Access and Maintenance) Easement(s) are hereby given and granted to the City, its successors and assigns, as an easement to provide visibility, right of access for maintenance upon and across said V.A.M. Easement. The City shall have the right but not the obligation to maintain any and all landscaping within the V.A.M. Easement. Should the City exercise this maintenance right, then it shall be permitted to remove and dispose of any and all landscaping improvements, including without limitation, trees, shrubs, flowers, ground cover and bushes. The City may withhold maintenance responsibility for the V.A.M. Easement until the ultimate owners. No building, fence, shrub, tree or other improvements or growths, which in any way may endanger or interfere with the visibility, shall be constructed in, over or across the V.A.M. Easement and to remove any obstruction thereon. The City, its successors, assigns or agents shall have the right to enter upon the V.A.M. Easement or to remove any part thereof for the purposes and with all rights and privileges set forth herein.

SPECIAL NOTICE:
 Setting a portion of this addition by metes and bounds is a violation of Ordinance and State law, and is subject to fines and withholding of utilities and building permits.

FLOOD HAZARD ZONE:
 F.I.R.M. Community Panel #8357C0270E dated September 26, 2008. This tract does not appear to be in a flood hazard zone according to the SPECIAL NOTES:
 This tract appears to be currently Zoned I - Interstate District.

STATE OF TEXAS
 COUNTY OF PARKER

BEFORE ME, the undersigned authority, a Notary Public in and for the State of Texas, on this day personally appeared PATRICK CARTER, Registered Public Land Surveyor, known to me to be the person whose name is subscribed to the above and foregoing instrument, and acknowledged to me that he executed the same for the purpose and considerations therein expressed.
 GIVEN UNDER MY HAND AND SEAL OF OFFICE on this the 25 day of November, 2009.
Patricia S. Carter
 Notary Public in and for the State of Texas

STATE OF TEXAS
 COUNTY OF PARKER

BEFORE ME, the undersigned authority, a Notary Public in and for the State of Texas, on this day personally appeared PATRICK CARTER, Registered Public Land Surveyor, known to me to be the person whose name is subscribed to the above and foregoing instrument, and acknowledged to me that he executed the same for the purpose and considerations therein expressed.
 GIVEN UNDER MY HAND AND SEAL OF OFFICE on this the 25 day of November, 2009.
Patricia S. Carter
 Notary Public in and for the State of Texas

CITY APPROVAL STATEMENT
 APPROVED BY THE CITY OF WEATHERFORD FOR FILING AT THE OFFICE OF THE COUNTY CLERK OF PARKER COUNTY, TEXAS.

RECOMMENDED BY:
 SIGNATURE OF CITY PLANNER
 DATE OF RECOMMENDATION: 12/1/2009
 CITY OF WEATHERFORD, TEXAS

APPROVED BY:
 SIGNATURE OF CITY MANAGER
 DATE OF APPROVAL: 12/1/09
 CITY OF WEATHERFORD, TEXAS

ATTEST:
 SIGNATURE OF CLERK
 DATE: 12/1/09
 CITY SECRETARY
 CITY OF WEATHERFORD, TEXAS

SURVEYOR:
 PATRICK CARTER, R.P.L.S.
 110 A PALO PANTO
 WEATHERFORD, TEXAS 76086
 817-594-0400

OWNER/DEVELOPER:
 NORTHSIDE BAPTIST CHURCH
 910 NORTH MAIN ST
 WEATHERFORD, TEXAS 76086
 817-598-9812

